



HINDALCO
EXTRUSIONS

EXPERTISE IS OUR STRENGTH



INDUSTRIAL MACHINERY
RENUKOOT

Printed Jan. 2018

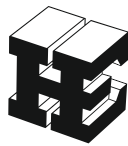

HINDALCO
EXTRUSIONS

EXPERTISE IS OUR STRENGTH



VISION

To be a premium metals major, global in size and reach, excelling in everything we do, and creating value for our stakeholders.

MISSION

To relentlessly pursue the creation of superior shareholder value, by exceeding customer expectation profitably, unleashing employee potential, while being a responsible corporate citizen adhering to our values.

VALUES

Integrity: Honesty in every action

Commitment: Deliver on the promise

Passion: Energized action

Seamlessness: Boundaryless in letter and spirit

Speed: One step ahead always





Contents

Page No.

Industrial Machinery

1. Hydraulic Pump.....	12
2. Actuator	14
3. Pneumatic System.....	17
4. Pneumatic Cylinder	18
5. Pneumatic Valve.....	19
6. Tobacco Stave	21
7. Vessels.....	22
8. Textile Machine Part	22
9. Textile Component	25
10. Machine Part	25
11. Machine Component	29
12. Medical Equipment.....	31
13. Index.....	33
14. Contacts.....	34

HINDALCO - An Overview

Hindalco Industries Limited, a USD 15 billion flagship company of the Aditya Birla Group, is a leading producer of aluminium and copper. Hindalco is present across the value chain of Aluminium & Copper. It has global footprint spanning across 13 countries in 5 continents

Aluminium

- Amongst top 5 aluminium majors worldwide.
- World's largest aluminium rolling company.
- Integrated operations - from mines to alumina to metal to value added products
 - ✦ Ingots & redraw rods (wire rods)
 - ✦ Flat Rolled products
 - ✦ Extrusions
 - ✦ Foils

Copper

- World's largest single-location copper smelting capacity.
- Copper mines in Australia.

Hindalco is a leader in Aluminium Extrusions industry in India with two manufacturing facilities. Both the plants are equipped with state of the art equipment, having well established manufacturing processes and quality systems honed over five decades.

- Manufacturing Facilities
 - ✦ Renukoot, U. P. (North India)
 - ✦ Alupuram, Kerala (South India)
- Capacity 60,000 MT per annum
- Expertise in customised alloys including hard alloys
- Catering to wide range of application segments such as Architectural, Electrical, Industrial, Transport, Defence and Consumer Durable.
- Extrusions manufactured from in-house virgin metal
- Quality Certification
 - ✦ ISO 9001-2008
 - ✦ ISO 14001-2004
 - ✦ OHSAS 18001-2007

This Catalogue covers the Transport sections from the range manufactured in the Renukoot plant of Hindalco



TABLE - 1

Wrought alloys: Near equivalent designations

INDIA		U.S.A. (A.A.)	BRITAIN (B.S.)	CANADA	GERMANY (DIN)	RUSSIA	I.S.O.	FRENCH ND
NEW I.S.	OLD I.S.							
19501	1E	1050(E.C)	1E	C 1S	E-Al 99.5	-	-	-
19500	1B	1050	1B	1S	A-99.5	-	Al-99.5	1050A
24345	H15	2014	H15	B26S	AL-CU-SI	AK	-	-
24534	H14	2017	H14	17S/16S	-	D1	Al-Cu-4Mg Si	-
-	-	2024	-	24S	Al-Cu.Mg2	-	Al-Cu-4Mg 1	2024
31000	N3	3003	N3	3S	Al-Mn	A-Mn	Al-Mn 1	3003
52000	N4	5052	N4	M57S	Al-Mg,2	A-Mg	Al-Mg-2.5	5051
53000	N5	5086	N5	54S	-	A-Mg-3	Al-Mg-4	-
54300	N8	5083	N8	D54S	Al-Mg-4.5 Mn	-	Al-Mg-4.5 Mn	5083
65032	H20	6061	H20	65S	Al-Mg-Si Cu	-	Al-Mg-1Si Cu	-
63400	H9	6063	H9	50S	Al-Mg-Si 0.5	-	Al-Mg Si	-
64430	H30	6351	H30	B51S	Al-Mg-Si 1	AV	Al-Si-1 Mg	6081
64423	H11	6066	H11	C62S	-	-	-	-
62400	-	6005	-	C51S	-	-	-	-
63401	91E	6101	91E	D50S	E,Al,Mg,Si 0.5	-	-	-
64401	-	6201	-	-	-	-	-	-
74530	-	7039	-	D74S	Al-Zn-Mg,1	-	-	3004
-	-	7075	DTD 5124	75S	Al-Zn-Mg Cu 1.5	-	Al-Zn 6 Mg Cu	7075



TABLE - 2

Wrought alloys: Guide to selection

Alloy	Temper	Resistance to Corrosion	Workability (Cold)	Machinability	Brazeability	Weldability	Commonly available forms	Indications of use
EC/1050, 1060 (1B) (19501) (19500) (19600)	F, O	A	A	D	A	A	Flats, Rods, Tubes & other section	Electrical conductors, cable sheathing, impact-extruded products, pressing utilities of anodizing quality, pen caps, piping etc.
1100 (1C) (19000)	F, O	A	A	D	A	A	Flats, Rods, Tubes & other section	Packaging lightly stresses and decorative assemblies in architecture and transport, equipment for chemical, food and brewing industries.
2014 (H 15) (24345)	T4 T6	C C	C D	B B	D D	C C	Rods & Bars Rods & Bars	Highly stressed component of all types in aircraft, ordnance and general engineering.
2017 (H 14) (24534)	T4	C	C	B	D	C	Rods & Bars	Highly stressed parts in aircraft and other structures, screw machine products.
2024	T4	C	C	B	D	C	Rods & Bars	Load Cell, Highly stressed component of all types in aircraft, ordnance and general engineering.
4043 (N 21) (43000)	F, O	A	A	D	A	A	Rods & other sections	Welding wire, architectural applications
5005 (52000A)	O, F	A	A	D	B	A	Flats, Rods, other sections	Structures exposed to marine attractive anodized finish, architectural, electrical conductors etc.
5052 (N 4)	O, F	A	A	D	C	A	Flats, Rods, Tubes & other sections	Structures exposed to marine atmosphere, aircraft parts, wire rope ferrules, rivet stock.
5086 (N 5) (53000)	O, F	A	A	D	D	A	Flats, Rods & other sections	Ship building and other marine applications, rivets, coinage etc.
5056 (N 6) (55000)	O, F	A	A	D	D	A	Rods	Zips, Welding Rods and Rivets.
6061 (H 20) (65032)	O, F T4 T6	A A A	A C D	D C C	A A A	A A A	Rods, Flats, Tubes & other sections	Heavy duty structures, building hardware, sections for bus body, truck and rail coach, furniture, rivets etc.
6063 (H9)	O, F T4 T6 T5	A A A A	A B C C	D C C C	A A A A	A A A A	Rods, Flats, Tubes & other sections	Building hardware, architectural section with good surface finish, medium strength furniture and anodized sections.



TABLE - 2

Wrought alloys: Guide to selection

Alloy	Temper	Resistance to Corrosion	Workability (Cold)	Machinability	Brazeability	Weldability	Commonly available forms	Indications of use
6066 (22450)	O, F T4 T6	B B B	B C C	D B B	A A A	A A A	Rods and other solid sections	For welded structures, textile parts, heavy duty machine parts.
6101 (91 E) (63401)	T4 T6	A A	B B	C C	A A	A A	Rods, Flats, Tubes & other sections	High strength electrical busbar sections.
6201 (64401)	T4	A	A	C	A	A	Redraw Rod	Overhead conductors, ACAR and AAAC
6351 (H 30) (6430)	O, F T4 T6	A A A	A C D	D C C	A A A	A A A	Rods, Flats, Tubes & other sections	Structural and general engineering items such as rail & road transport vehicles, bridges, cranes, roof trusses, rivets etc.
7039 (D74S) (74530)	O, F T4 T6	A A A	A C D	D C C	A A A	A A A	Flats, Tubes, Rods & other sections	Defence structures like mobile bridges etc. Tread and chequered plates, Excellent welding property with no loss of strength in welded zone.
7075 (DTD5124)	O, F T4 T6	A A A	A A D	A A A	A A A	A A A	Rods	Highly stressed structural applications

Notes:

- Relative ratings for corrosion, workability and machinability in decreasing order of merit A, B, C and D.
- Weldability & brazeability ratings A, B, C and D are relative ratings defined as follows:
 - Generally weldable by the commercial procedure & methods.
 - Weldable with special technique.
 - Limited weldability due to crack sensitivity or loss in corrosion resistance and mechanical properties.
 - Generally not weldable.
- Availability of other forms subject to special enquiries and methods.



TABLE - 3

Wrought alloys: Chemical composition limits (per cent)

Alloy (ISS) Old	New	Equivalent alloy (AA) U.S.A.	Copper		Magnesium		Silicon		Iron Max.	Manganese		*Others (Total) Max.	Remarks
			Min.	Max.	Min.	Max.	Min.	Max.		Min.	Max.		
1C	19000	1100	-	0.10	-	-	-	0.5	0.6	-	0.1	0.1	Aluminium 99.0% Min
1 B	19500	1050	-	0.05	-	-	-	0.25	0.4	-	0.05	0.1	Aluminium 99.5% Min
1 E	19501	-	-	0.04	-	-	-	0.15	0.35	-	0.03	0.1	Aluminium 99.5% Min
-	19600	1060	-	0.05	-	-	-	0.25	0.35	-	0.03	0.1	Aluminium 99.6% Min
H 15	24345	2014	3.8	5.0	0.2	0.8	0.5	1.2	0.7	0.3	1.2	0.5	-
H 14	24534	2017	3.5	4.7	0.4	1.2	0.2	0.7	0.7	0.4	1.2	0.5	-
		2024	3.8	4.9	1.2	1.8	-	0.5	0.5	0.3	0.9	0.15	Zn 0.25
N 3	91000	3003	-	0.1	-	0.1	-	0.6	0.7	1.0	1.5	0.4	-
		4032	0.8	1.3	0.8	1.3	-	13.5	0.6	-	0.2	0.15	Ni 0.8 - 1.3
N 4	52000	5052	-	0.1	1.7	2.6	-	0.6	0.5	-	0.5	0.4	Cr + Mn = 0.5
M 5	53000	5086	-	0.1	2.8	4.0	-	0.6	0.5	-	0.5	0.4	Cr + Mn = 0.5
N 8	54300	5083	-	0.1	4.0	4.9	-	0.4	0.7	0.5	1.0	0.4	Chromium up to 0.25
H 20	65032	-	0.15	0.4	0.7	1.2	0.4	0.8	0.7	0.2	0.8	0.4	**Cr = 0.15 - 0.35
-	-	6061	0.15	0.4	0.8	1.2	0.4	0.8	0.7	-	0.15	0.4	Chromium 0.04 to 0.35
H 9	63400	6063	-	0.1	0.4	0.9	0.3	0.7	0.6	-	0.3	0.4	-
-	-	6066	0.7	1.2	0.8	1.4	0.9	1.8	0.7	0.6	1.1	0.4	-
-	-	64423	0.5	1.0	0.5	1.3	0.7	1.3	0.8	-	1.0	-	-
9 1E	63401	6101	-	0.05	0.4	0.9	0.3	0.7	0.5	-	0.03	0.1	-
H 30	64430	6351	-	0.1	0.4	1.2	0.6	1.3	0.6	0.4	1.0	0.3	-
		6082	-	0.1	0.6	1.2	0.7	1.3	0.5	0.4	1.0	0.3	Chromium up to 0.25
-	74530	7039	-	0.2	1.0	1.5	-	0.4	0.7	0.2	0.7	0.4	Zinc 4.0 - 5.0 %
-	-	7075	1.2	2.0	2.1	2.9	-	0.5	0.5	-	0.3	0.2	Zinc (5.1 - 6.1) % & Chromium(0.18-0.28) %

* Titanium and/or other grain refining elements

** Either Mn or Cr shall be present



TABLE - 4

Wrought alloys: Mechanical properties

Heat Treatable Alloys					
Alloy A A Old (ISS) New (ISS)	Temper	Ultimate Tensile Strength Kg/mm ²		0.2% Proof Stress Kg/mm ²	Elongation On 50mm GL
		Min.	Max.		
2014 [H15] [24345]	T4[W]	39	-	24.0	10
	T6 [WP]	49	-	43.0	6
2017 [H14] [24534]	T4[W]	39	-	24.0	10
2024 [H9]	T4	40.5	-	26.5	12
6063 [H9] [63400]	T4[W]	14	-	8.0	14
	T6 [WP]	19	-	15.5	7
6061 [H20] 65032]	M	11.2	-	5.1	12
	T4[W]	19	-	11.5	14
	T6 [WP]	28.5	-	24.0	7
6351[H30] [64430]	M	11.2	-	8.2	12
	T4[W]	19	-	12.0	14
	T6 [WP]	31.5	-	27.5	7
6066	M	11.0	-	-	12
	T4[W]	28	-	17.5	14
	T6 [WP]	35	-	31.5	7
6101[91E] [63401]	T4[W]	14	-	8.0	12
	T6 [WP]	20.5	-	17.0	10
6201 [64401]	T4[W]	16	-	7.0	14
	T8 [WDP]	32	-	-	3
7039 [74530]	T4[W]	28	-	23.5	9
	T6 [WP]	31.5	-	26.5	7
7075	T6 [WP]	54	-	46.5	6

Properties indicated herein are typical properties and are given for information only. However properties of all the profiles in specific alloy shall be as per I. S. Specification.



Hydraulic pump

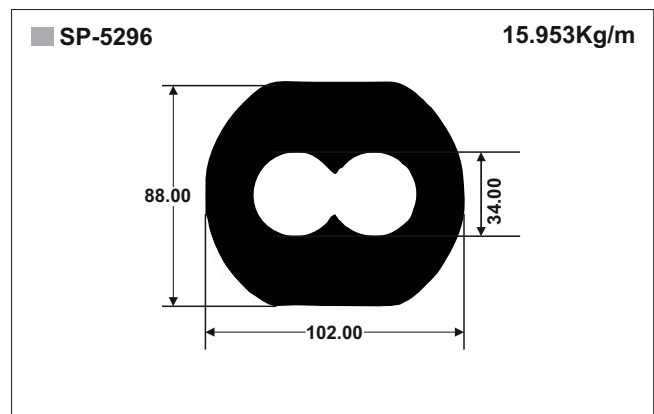
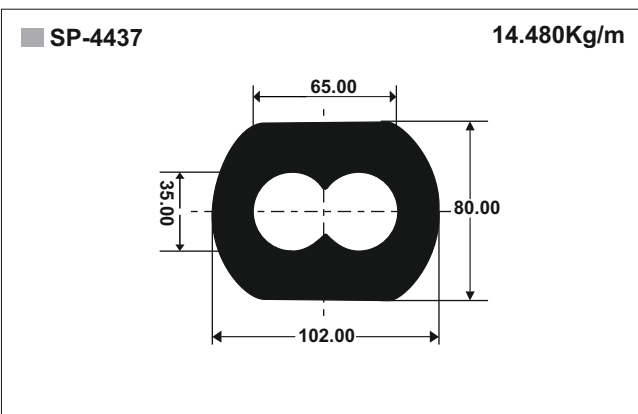
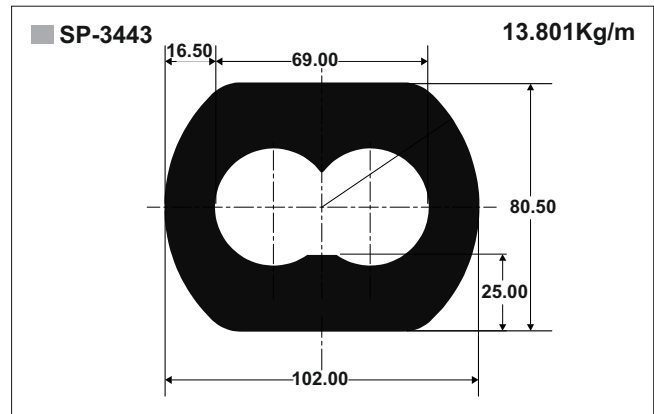
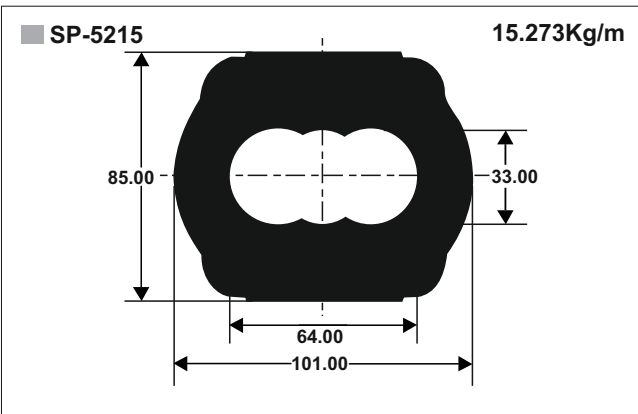
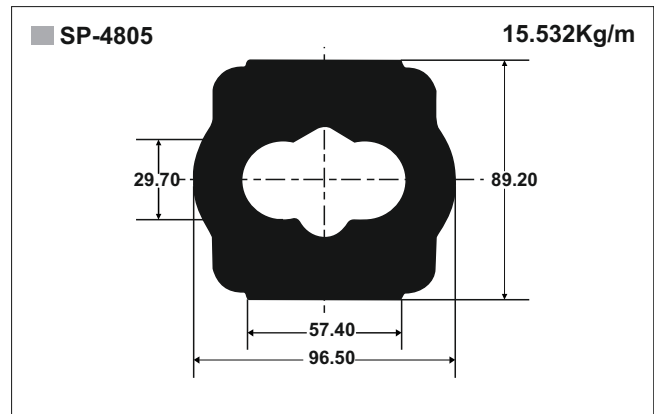
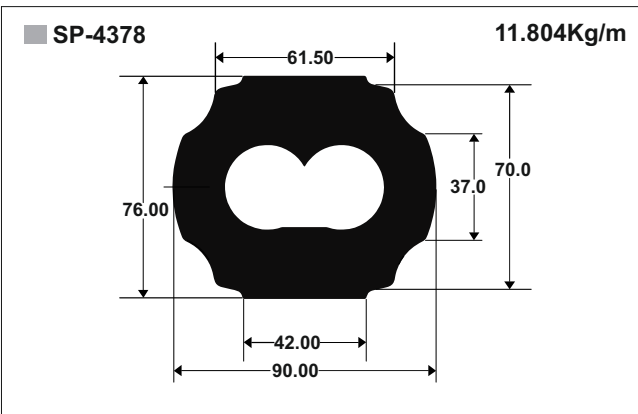
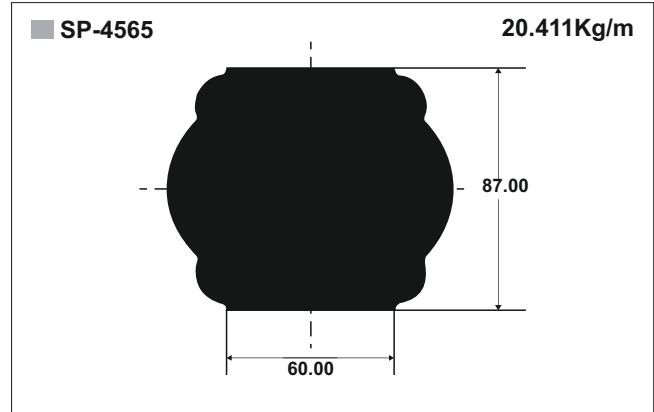
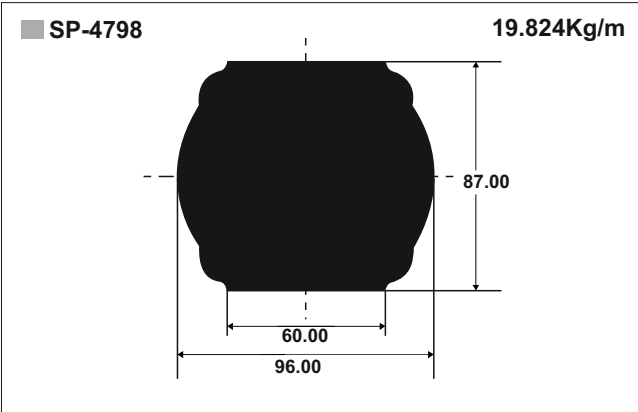



Hydraulic Pump

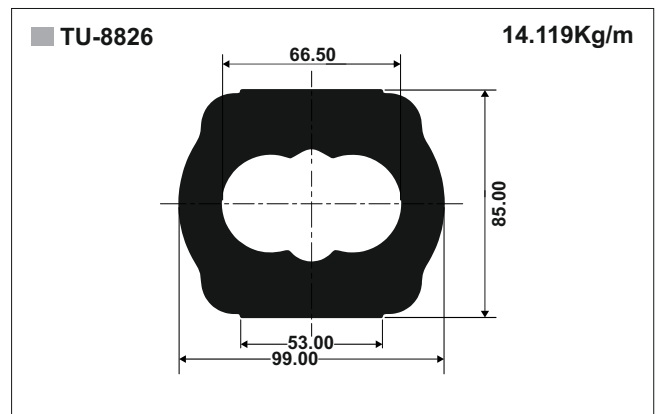
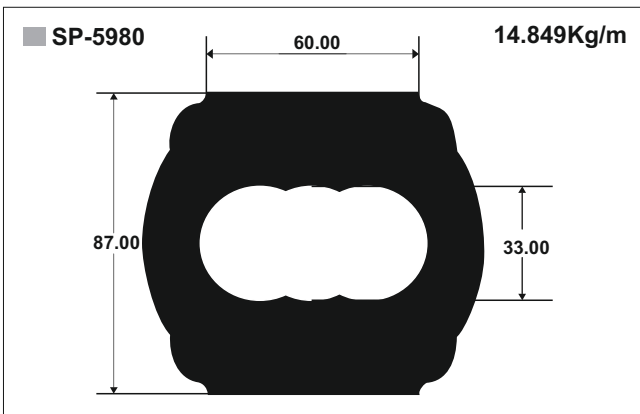
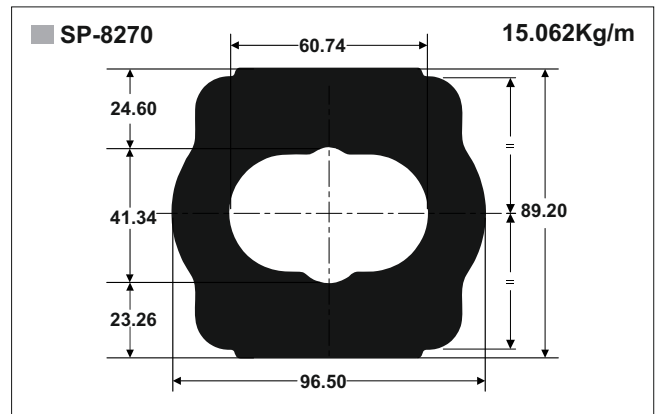
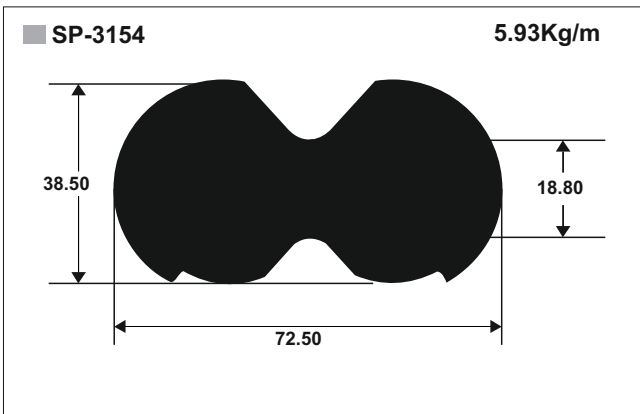
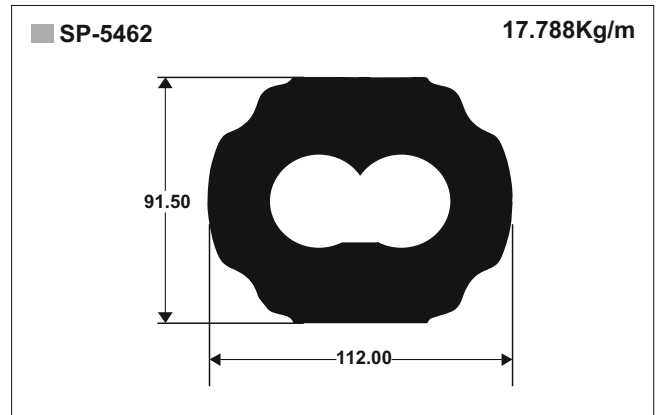
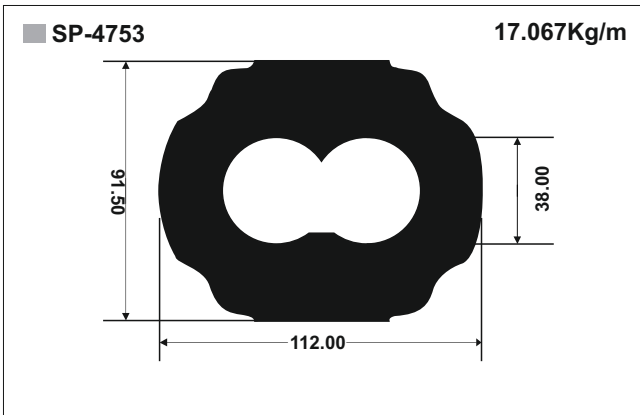



Actuator

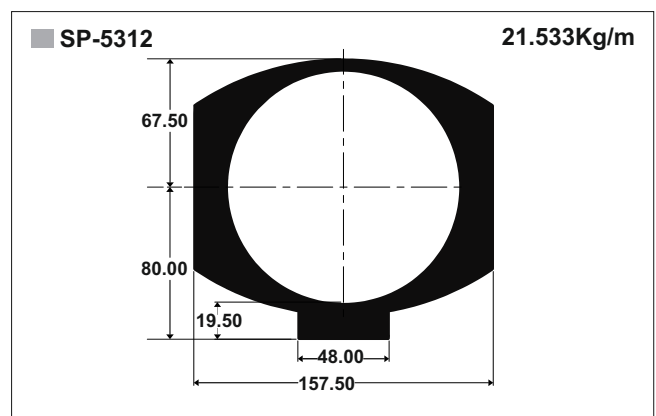
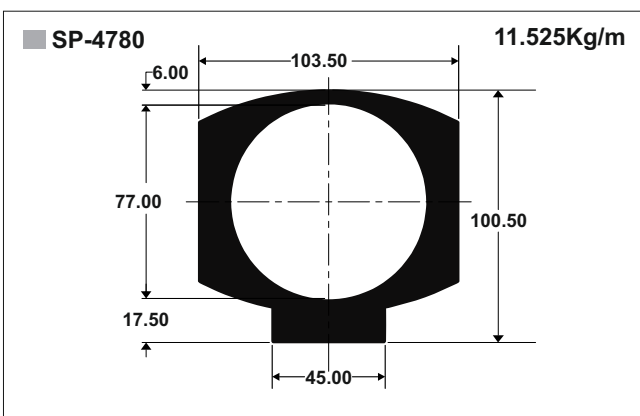
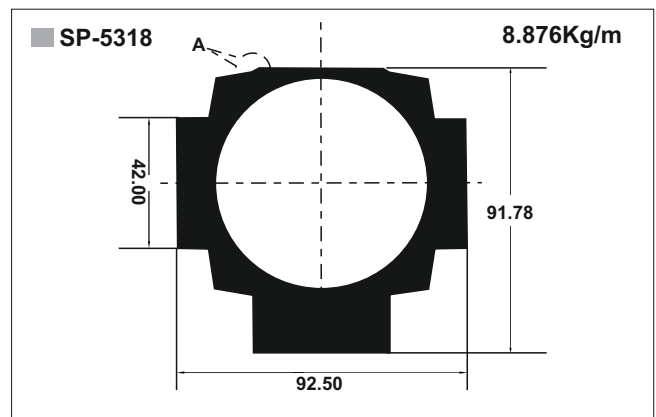
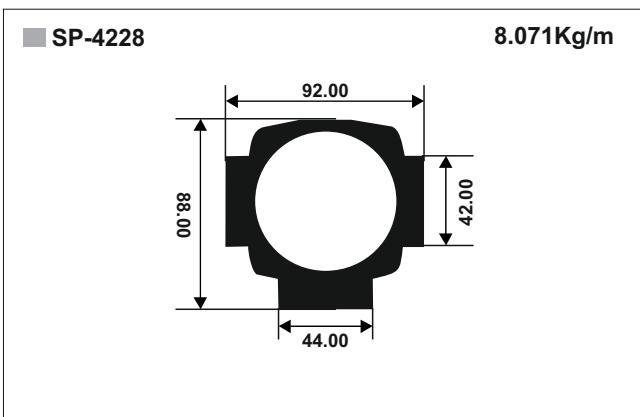
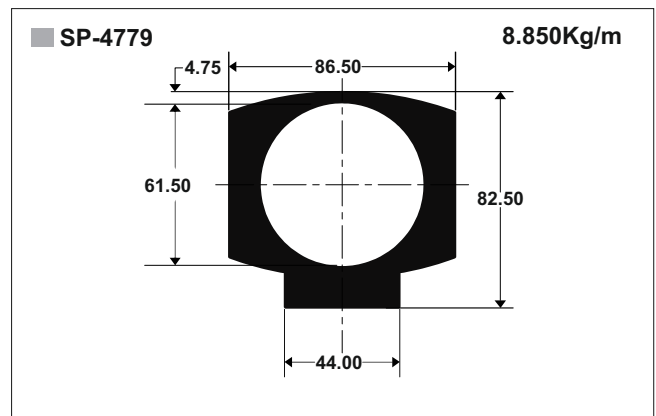
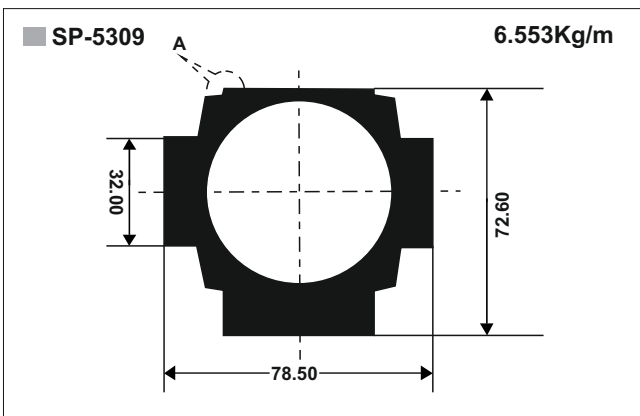
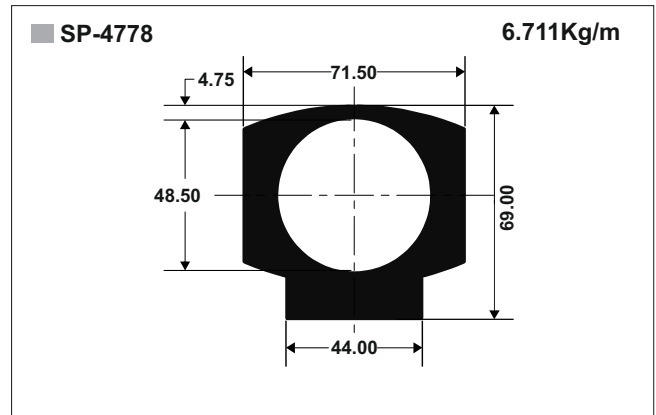
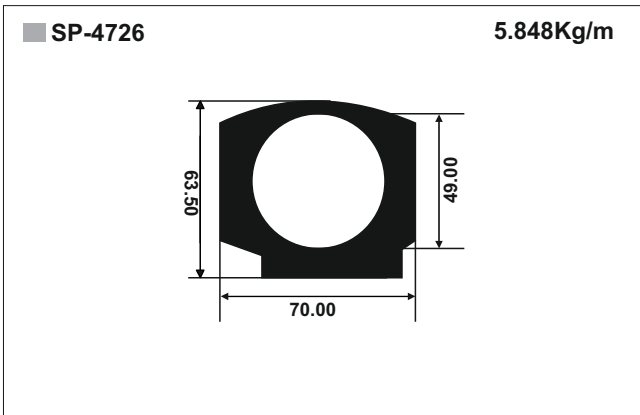



Actuator

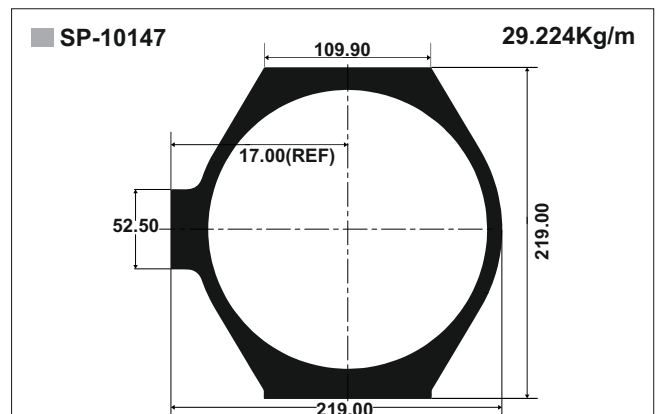
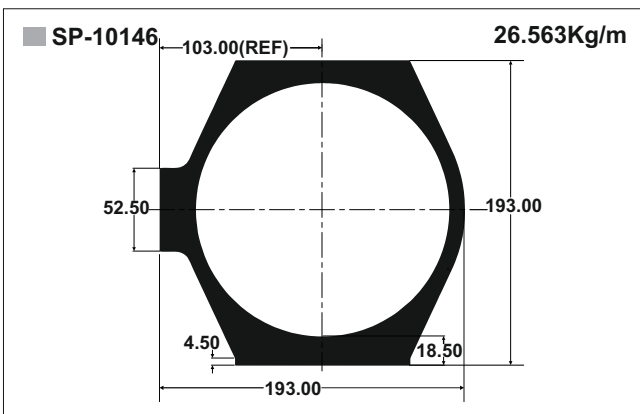
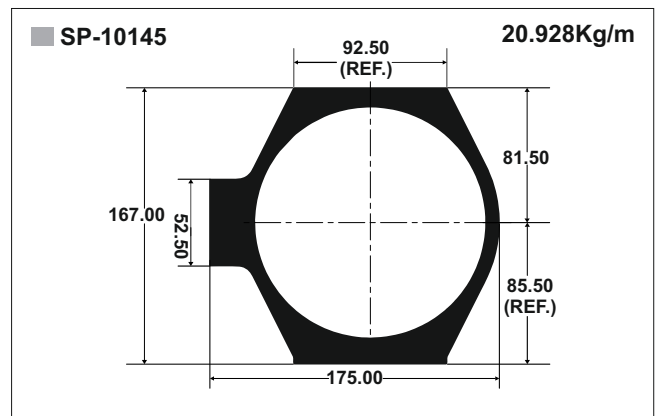
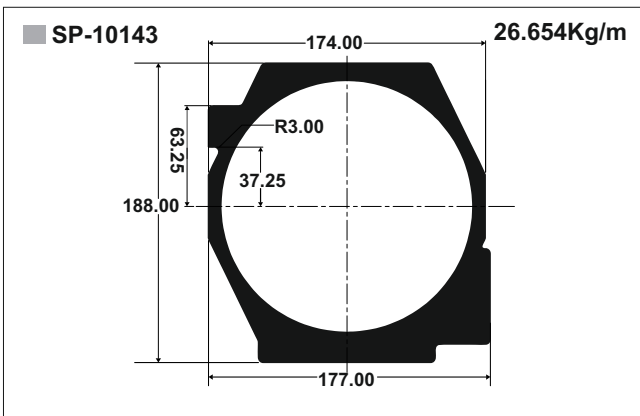
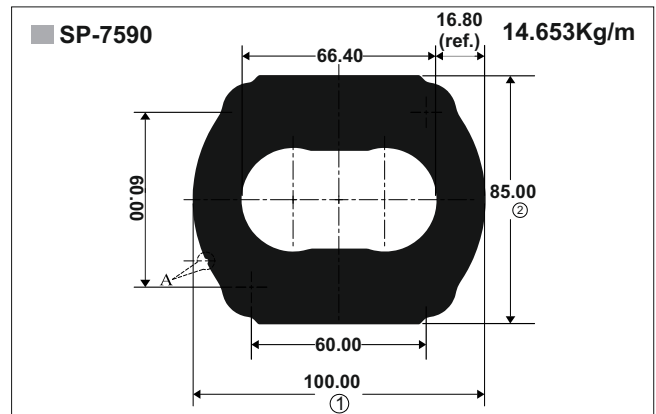
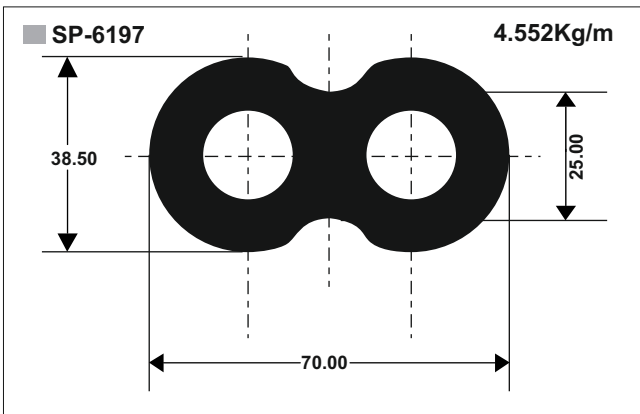
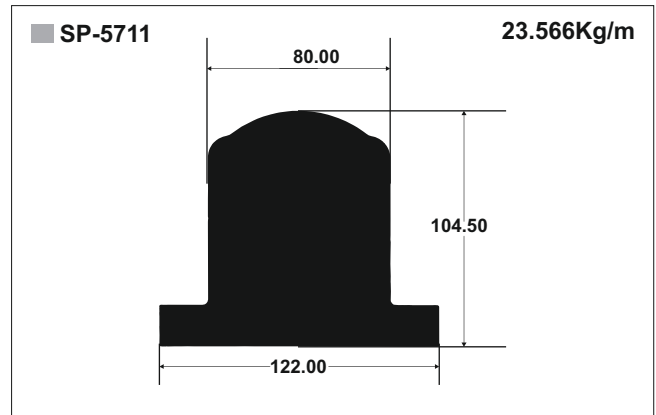
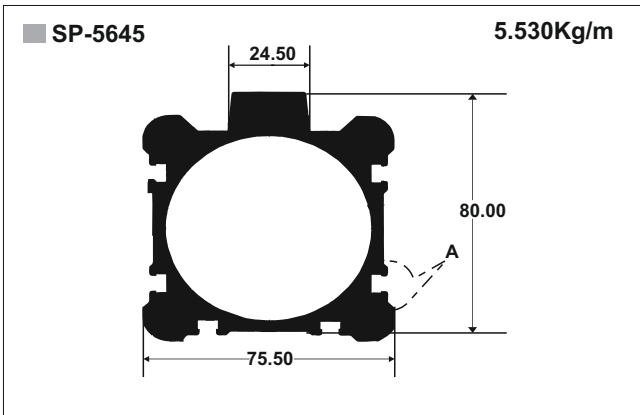



Actuator

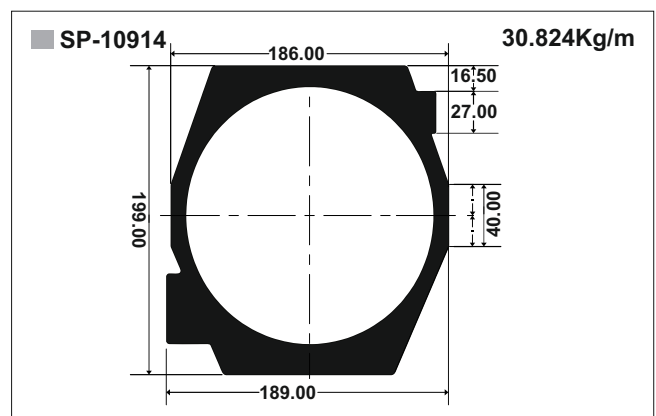
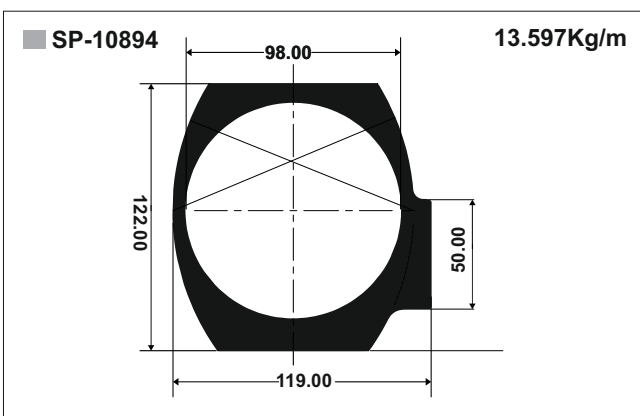
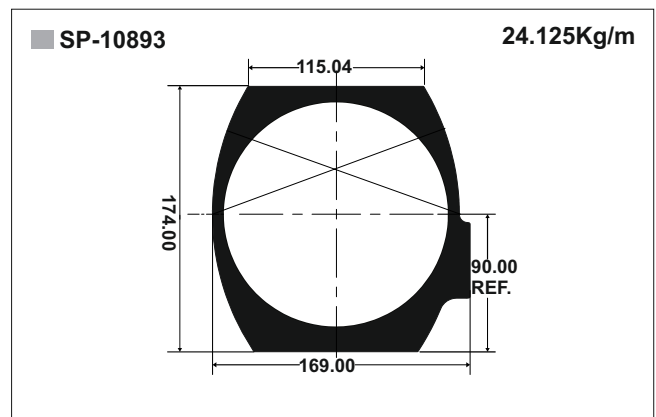
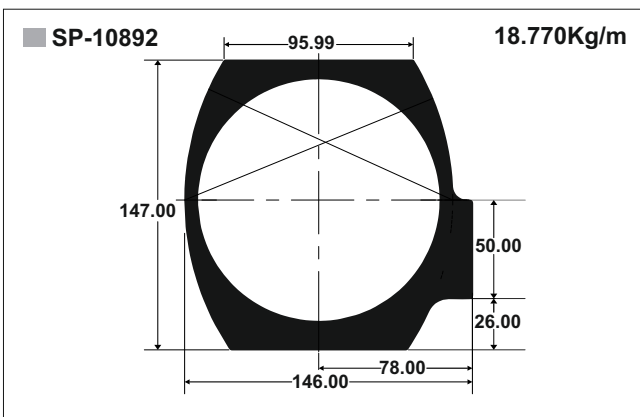
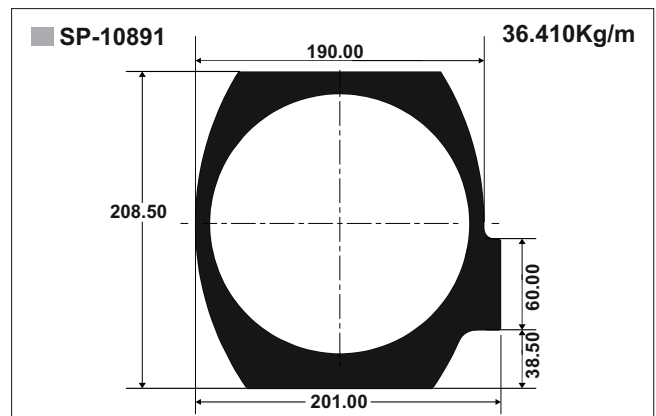
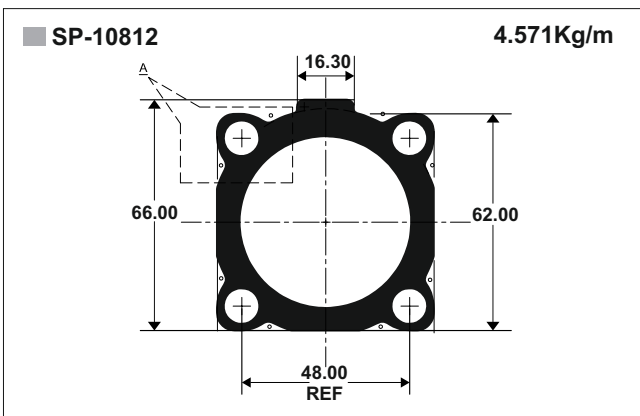
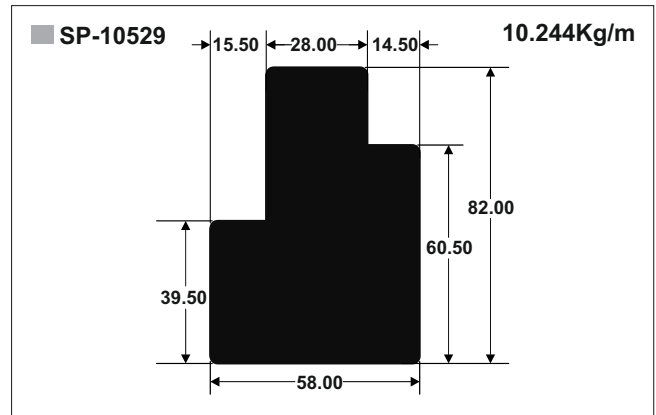
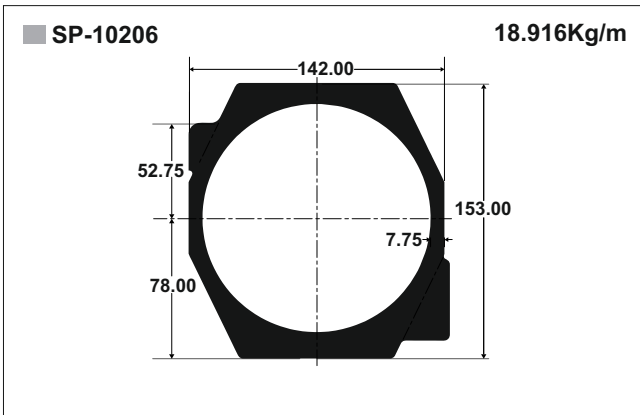



Actuator

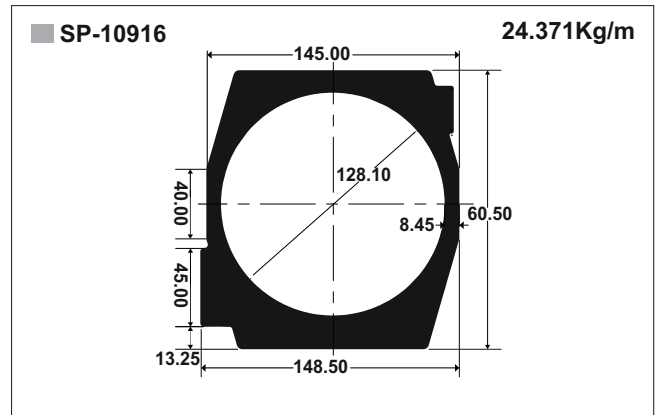
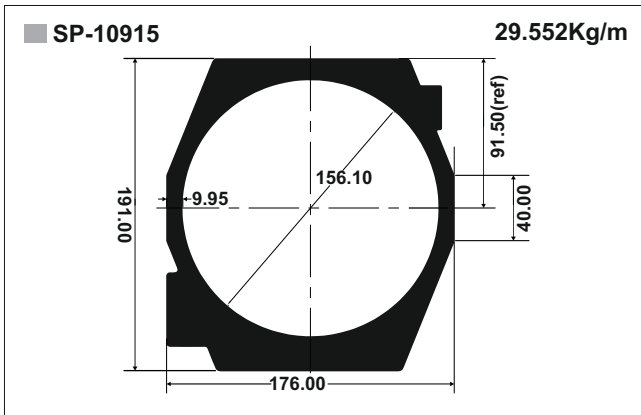

Pneumatics System

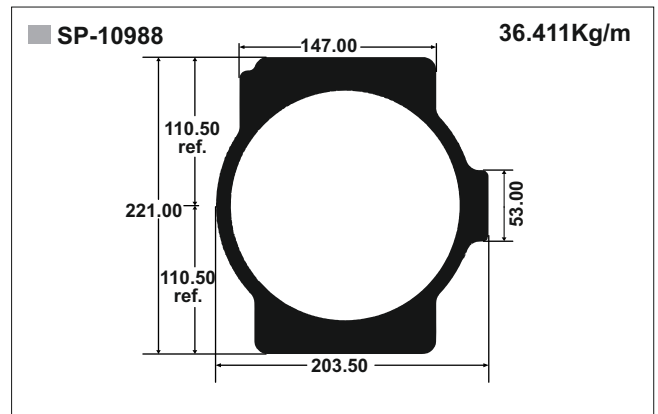
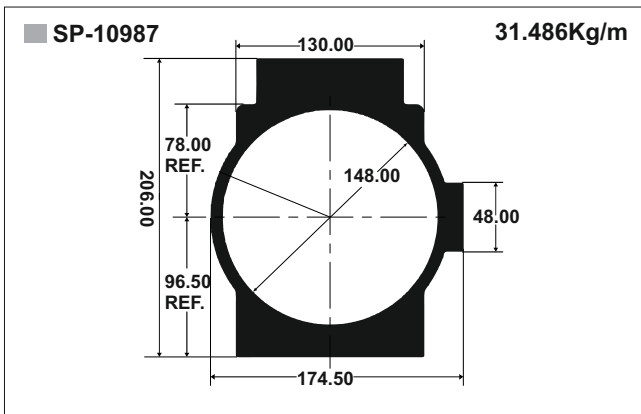



Pneumatic Cylinder

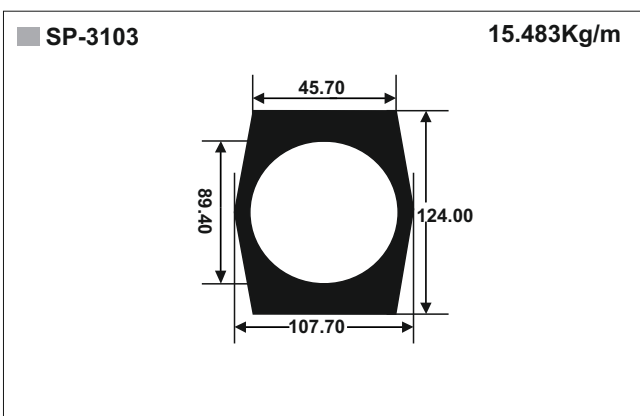
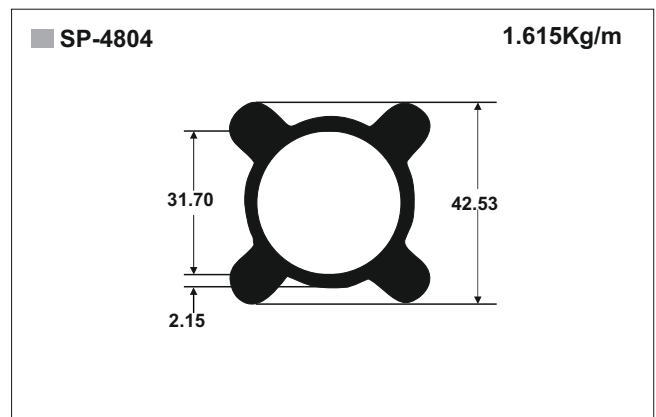
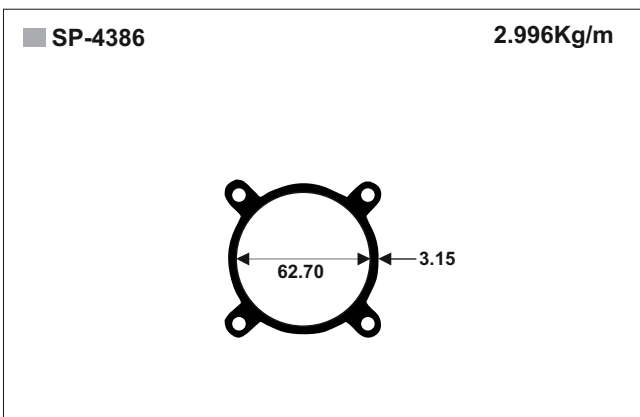
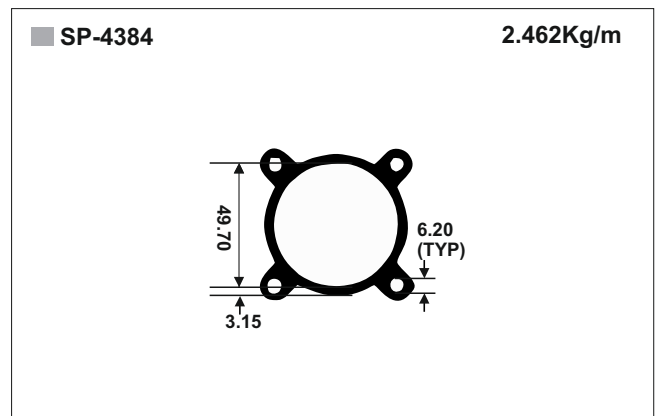
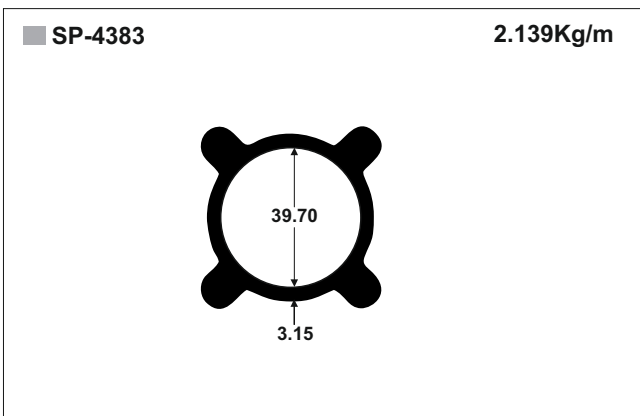
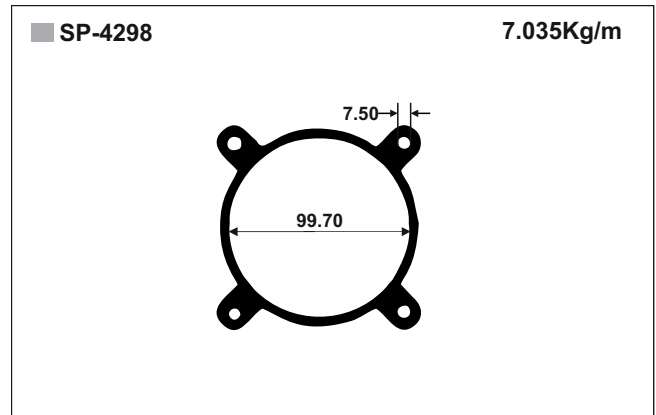
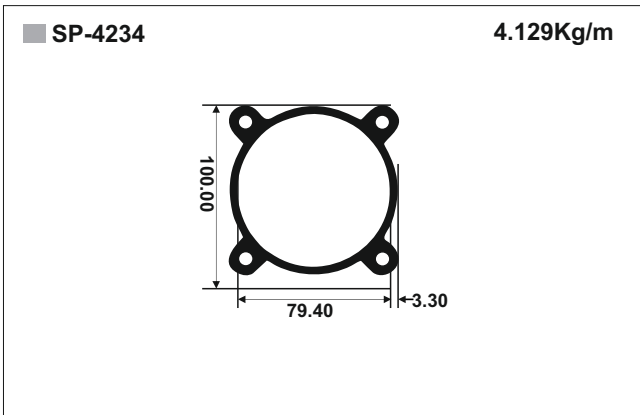



Pneumatics - Valves

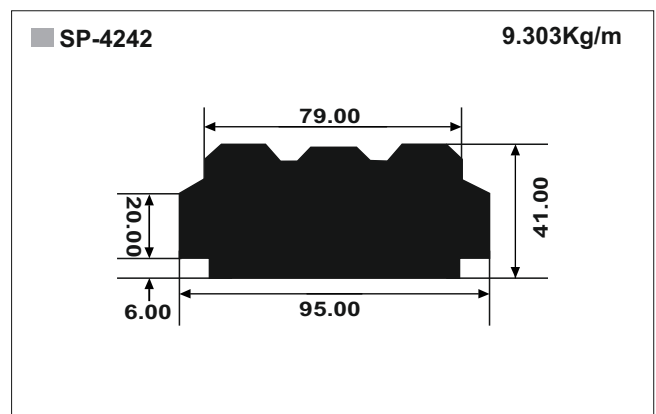
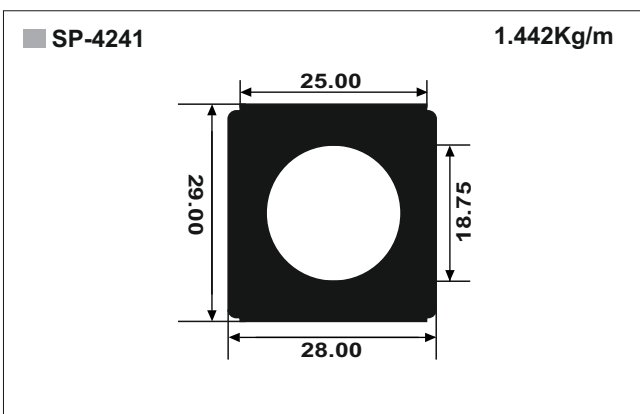
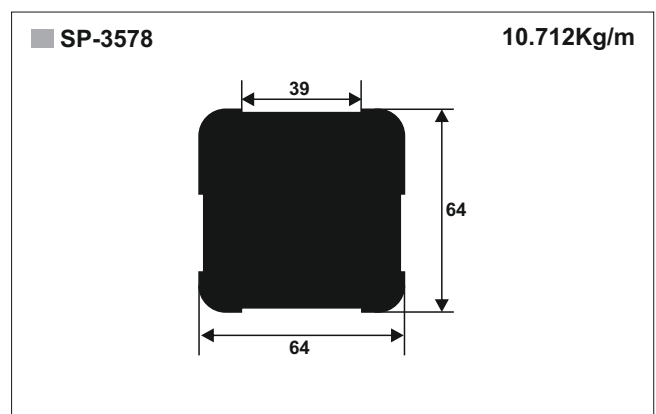
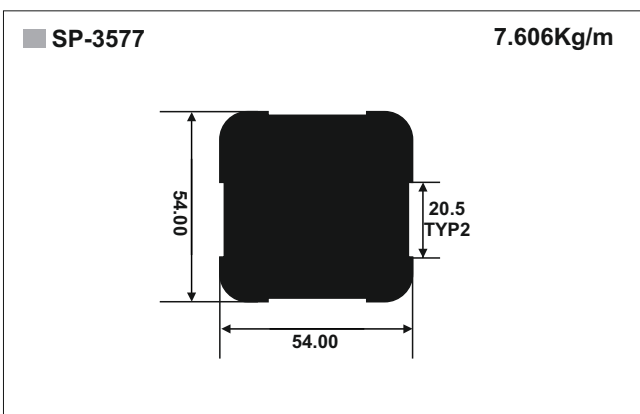
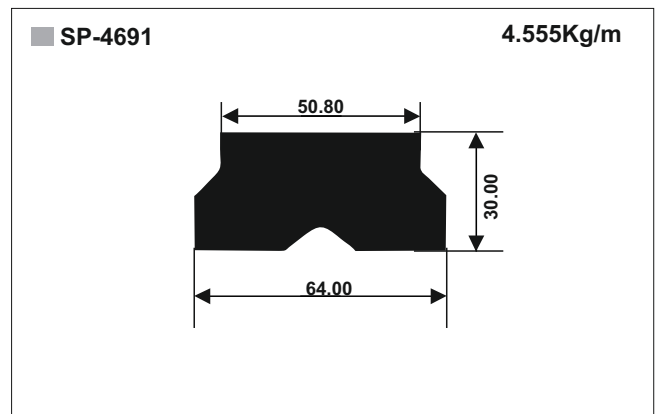
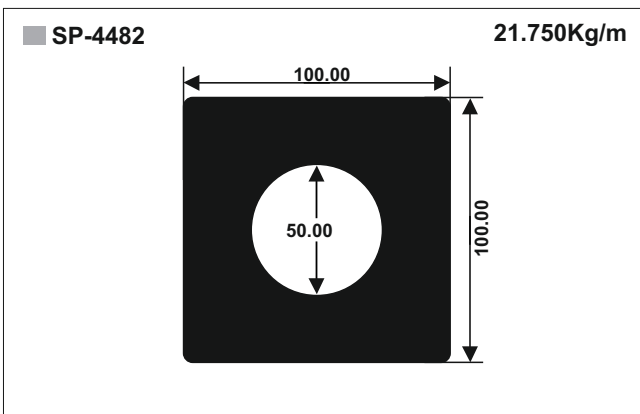
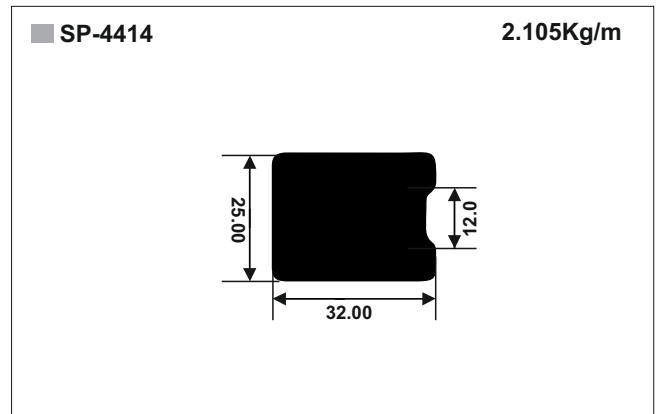
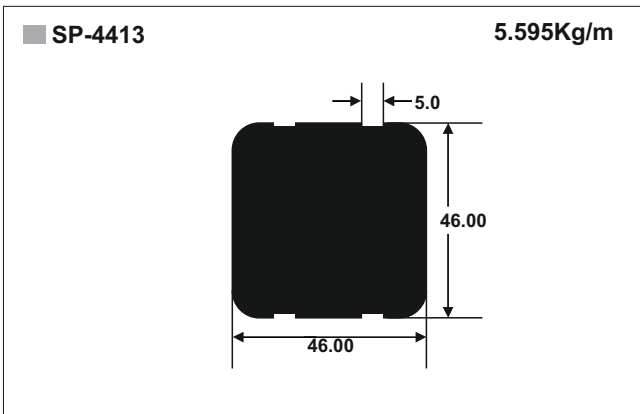



Pneumatics - Valves

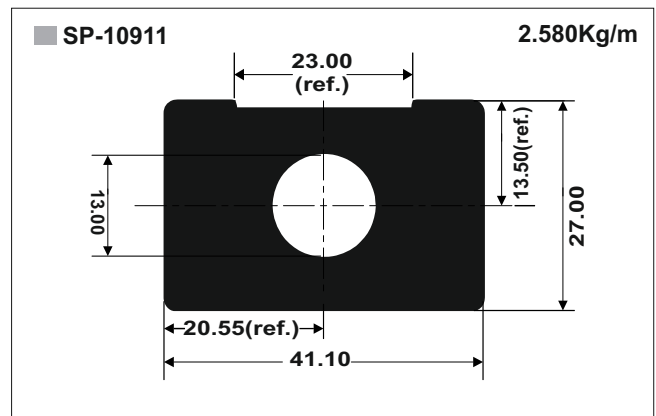
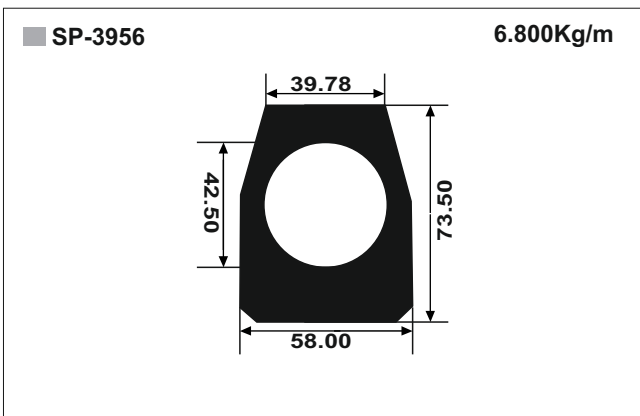
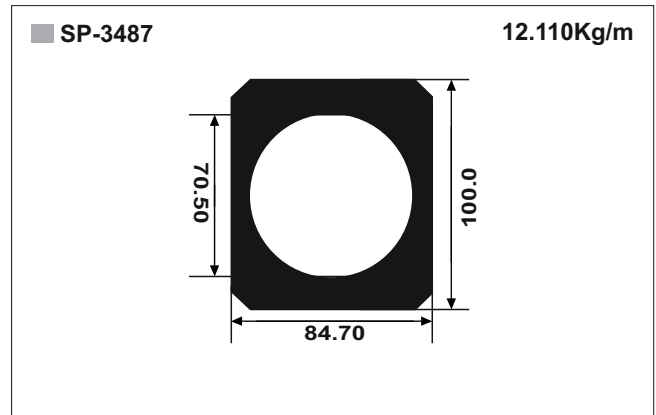
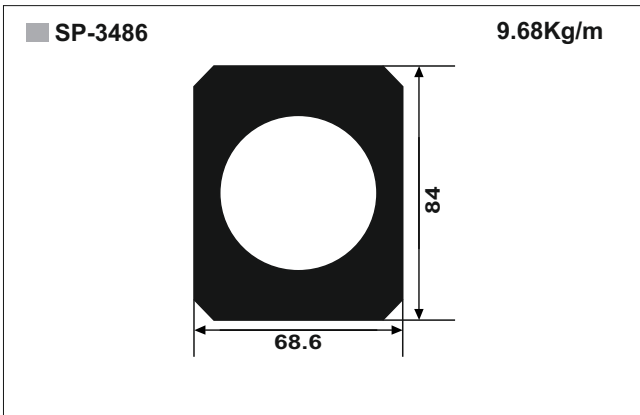



Tobacco Stave

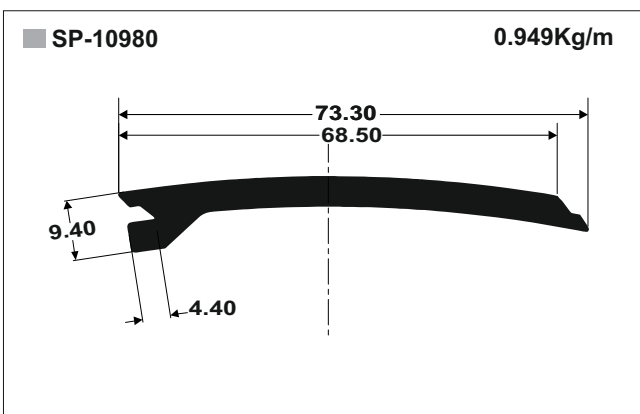
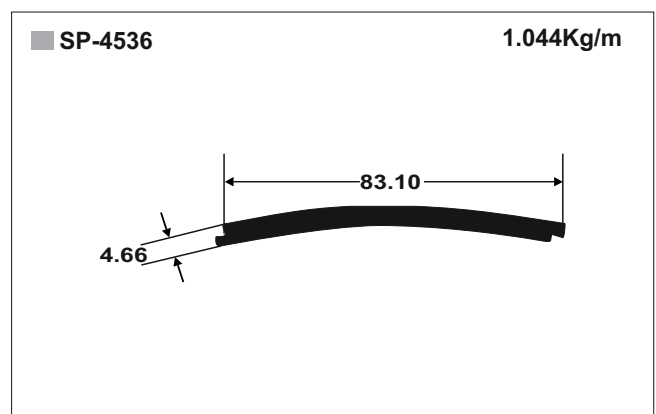
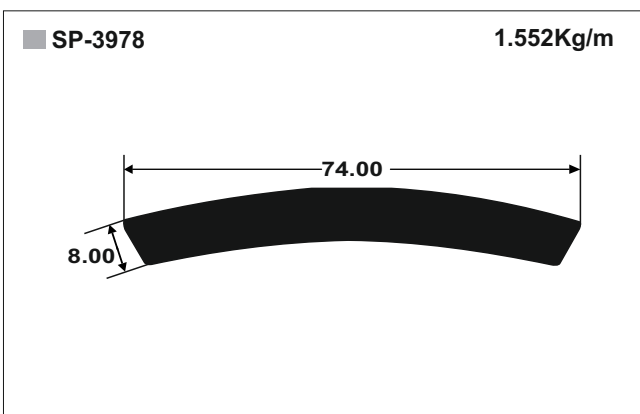
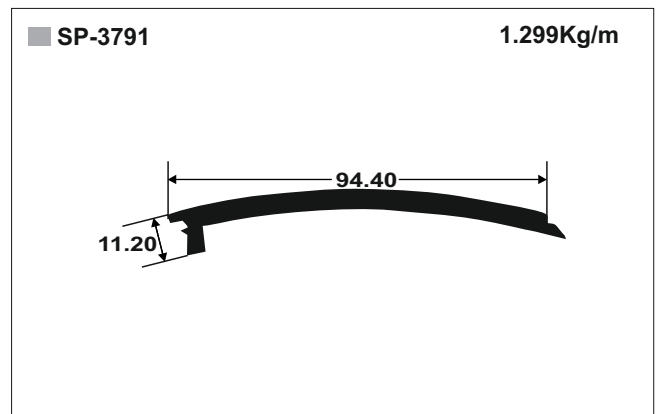
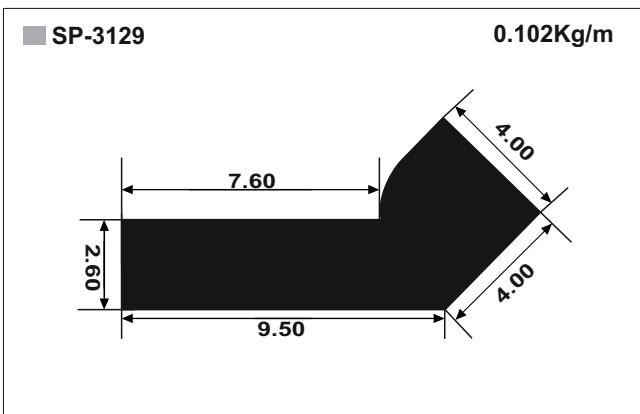
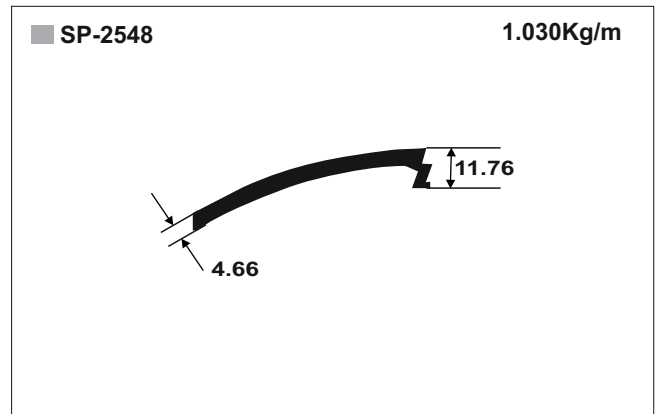
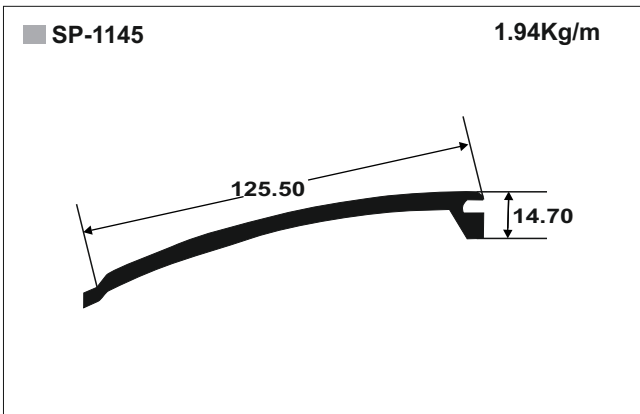



Vessels

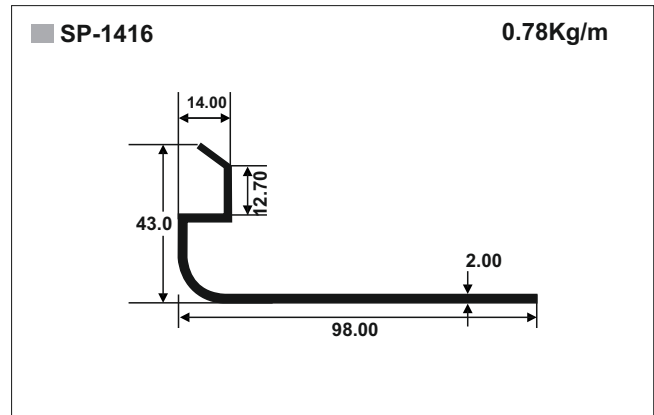
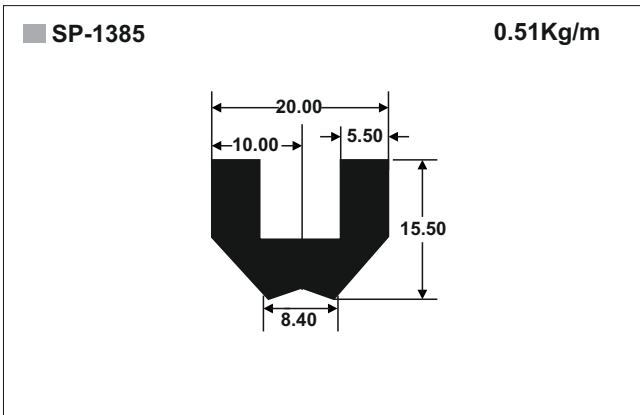

Vessels - Heat Exchanger

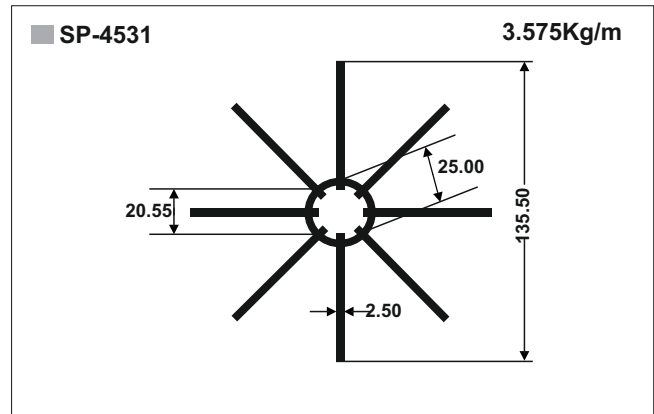
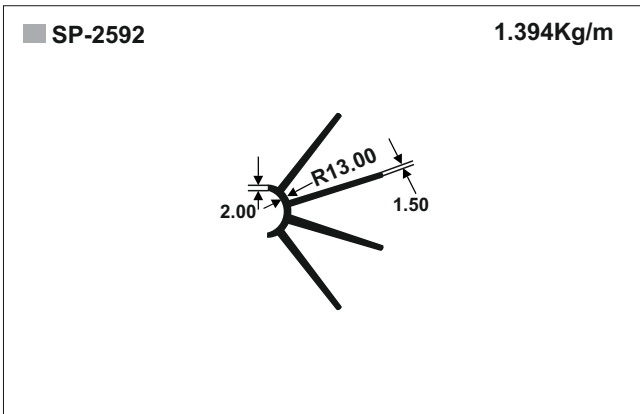

Textile Machine Part

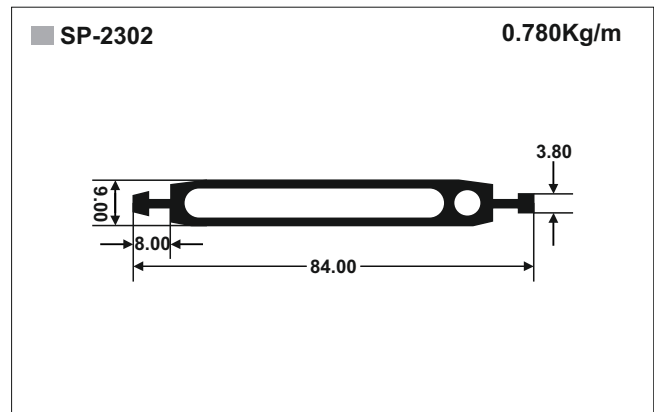
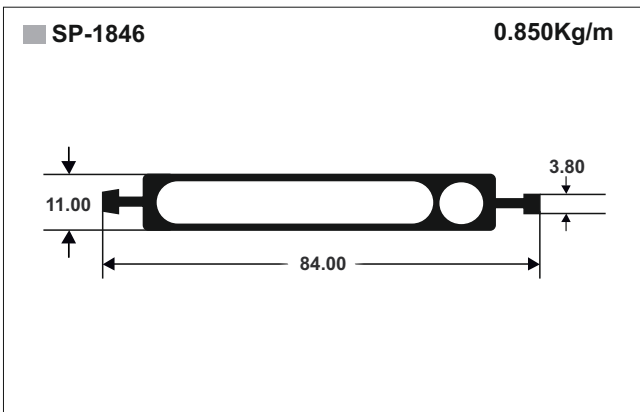
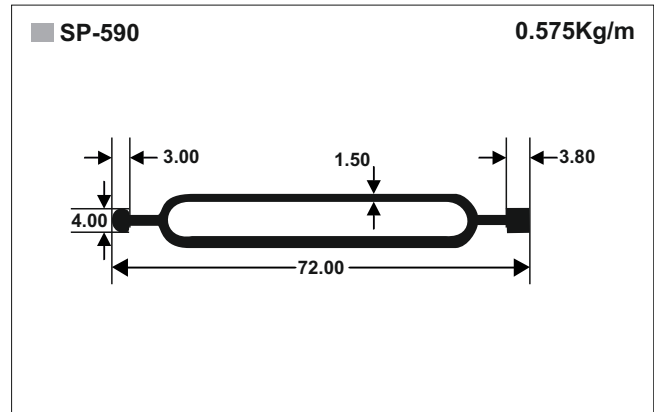
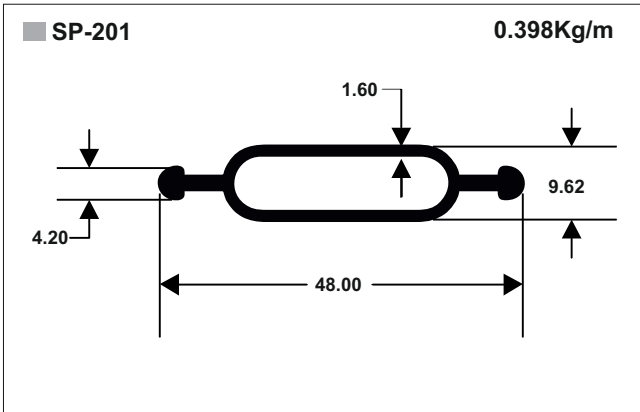



Textile Machine Part

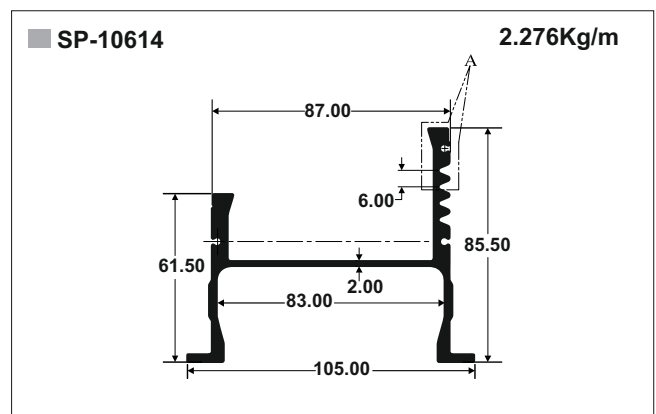
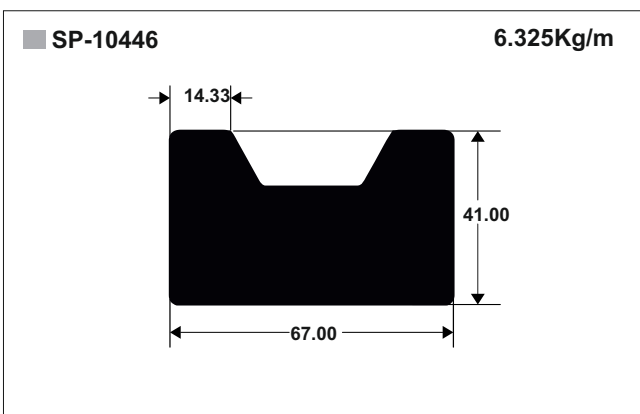
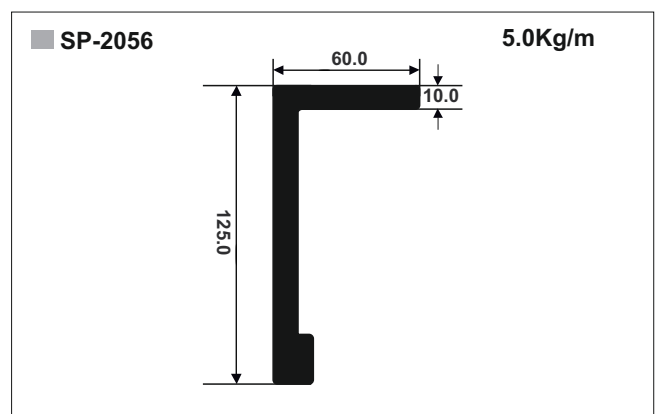
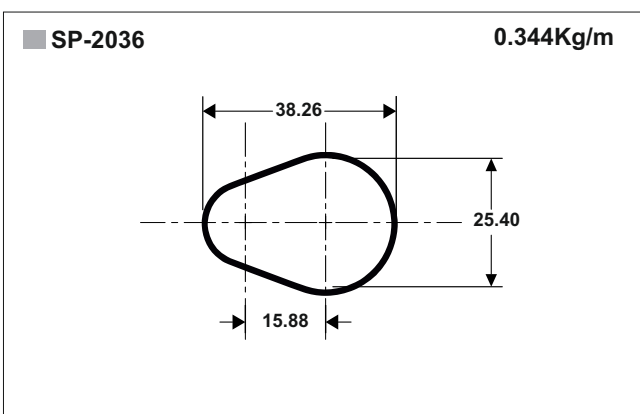
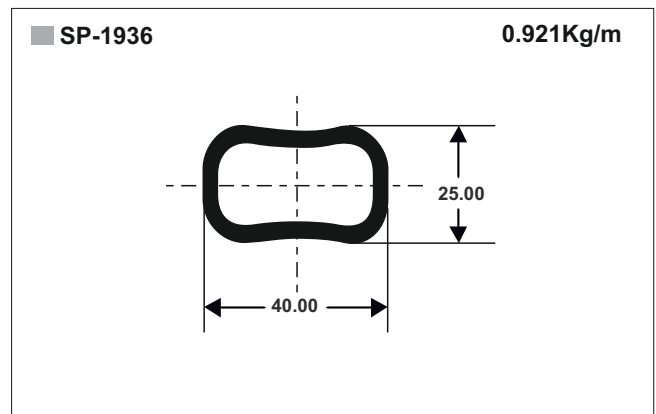
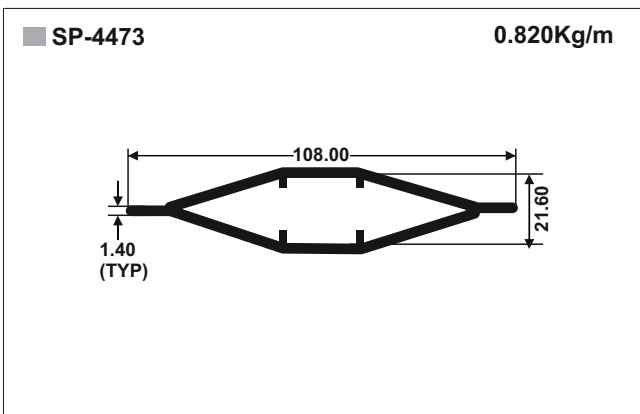
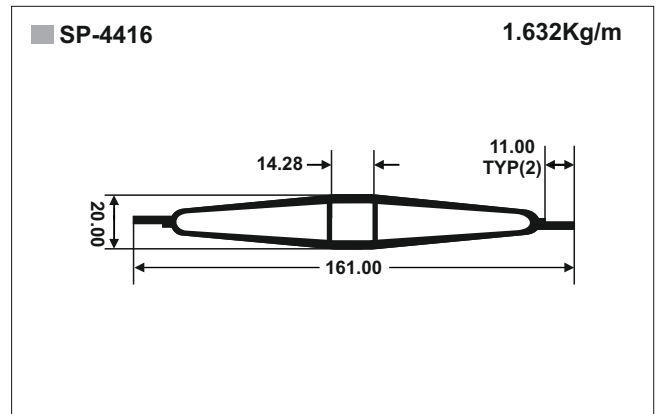
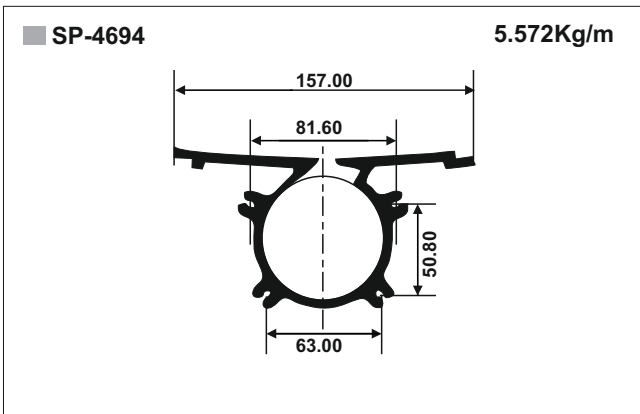



Textile Machine Part

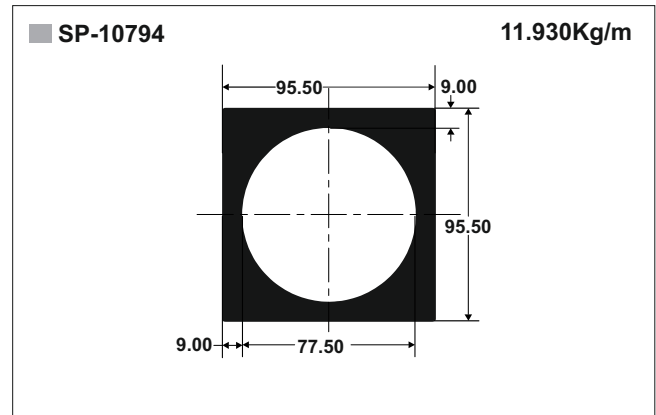
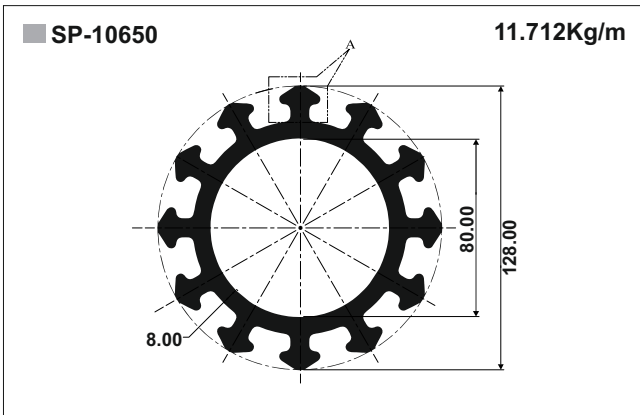

Textile Spindle

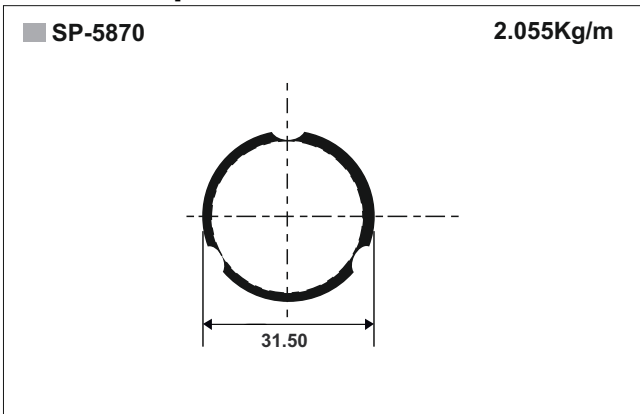



Textile Components

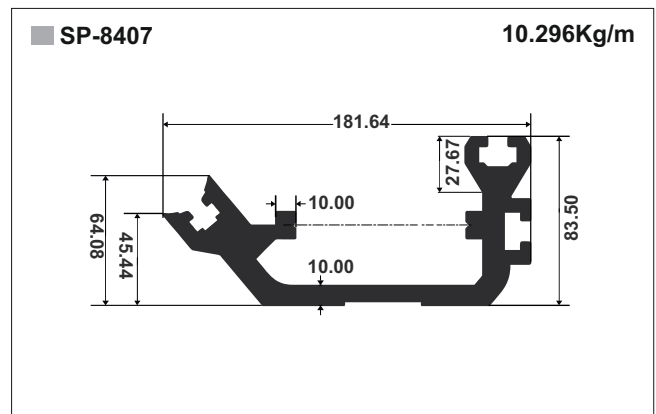
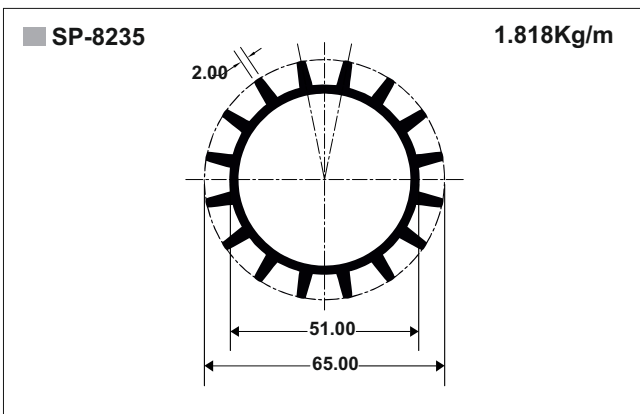
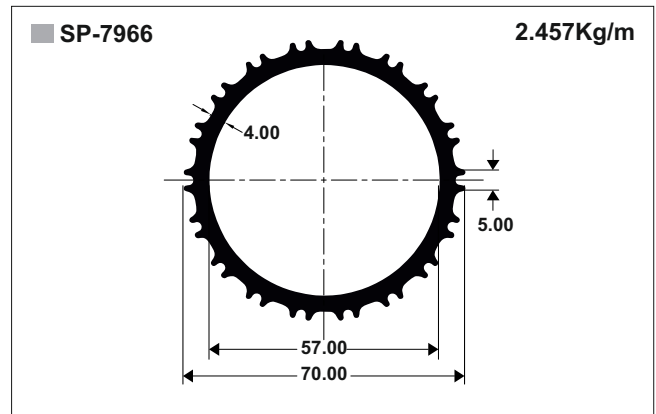
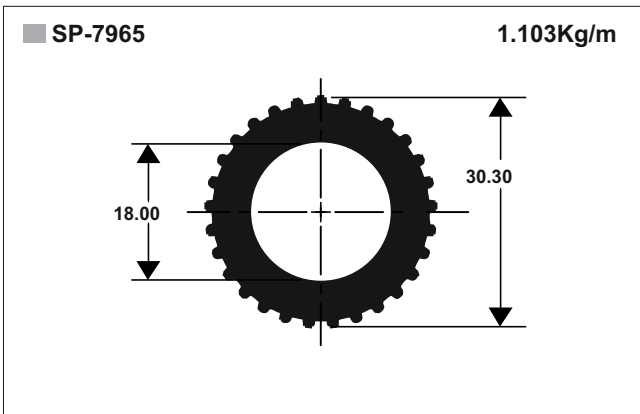

Machine Part

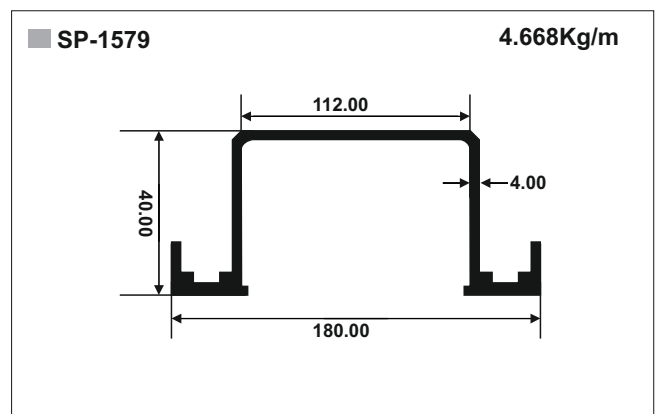
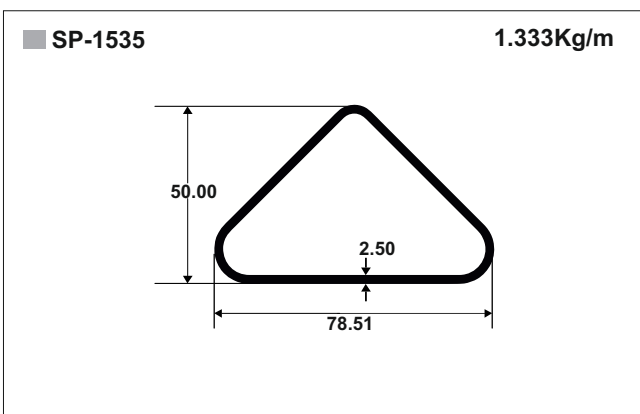
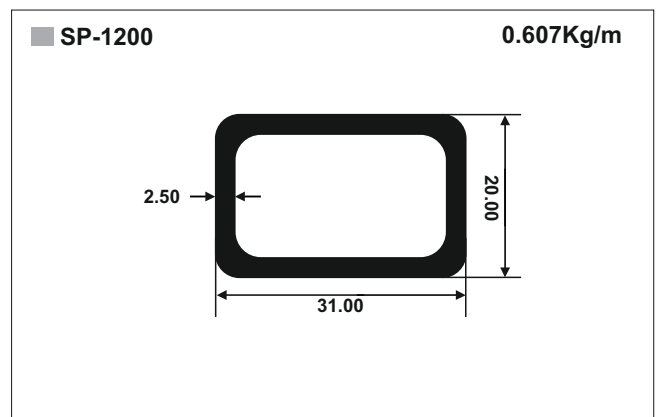
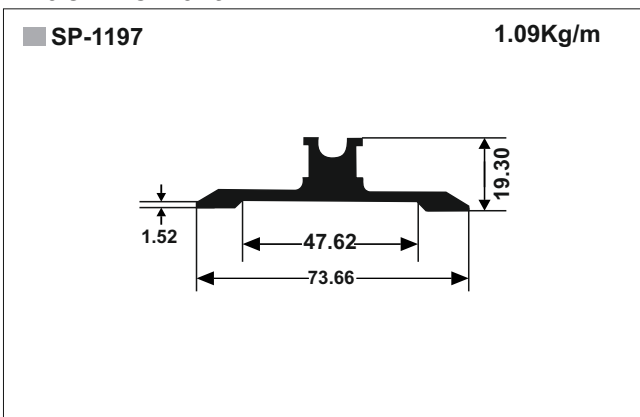



Machine Part

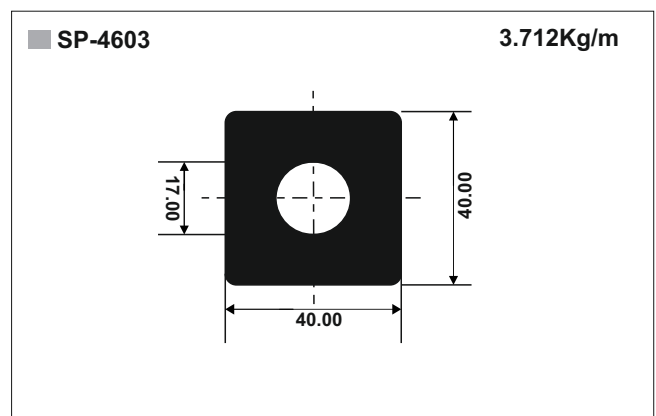
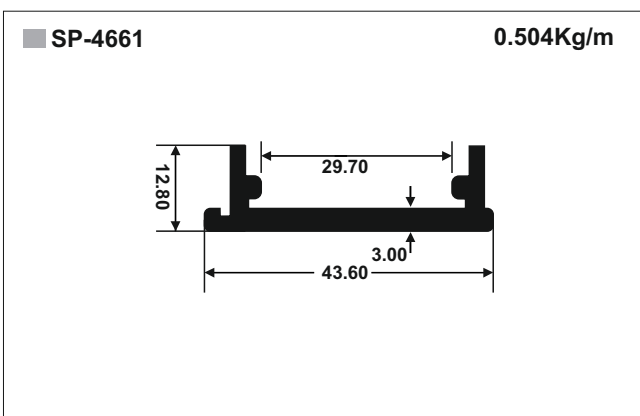
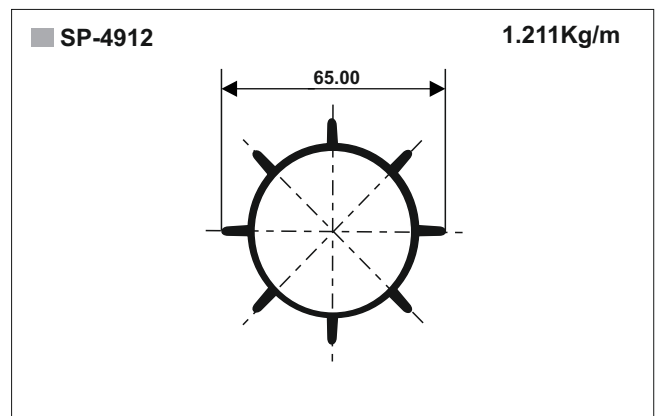
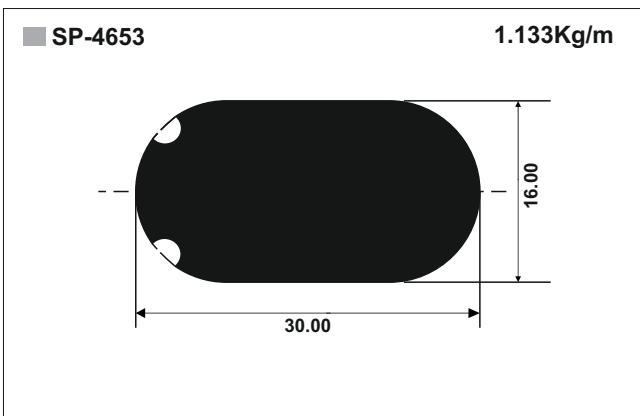
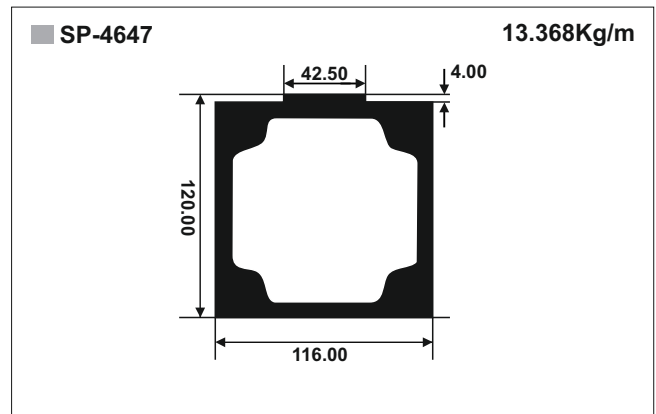
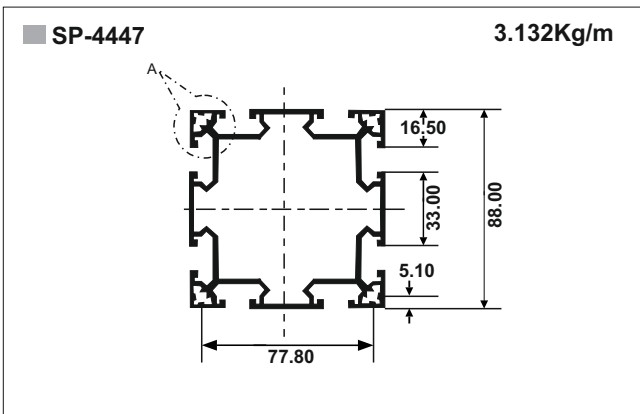
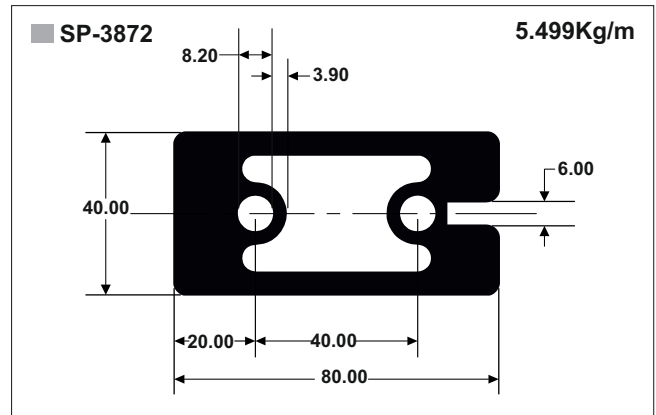
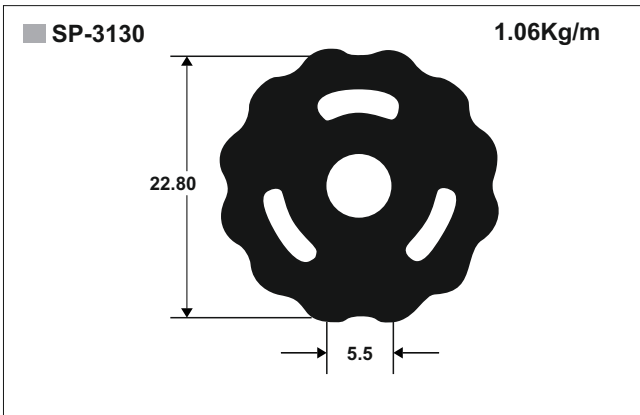



Machine Part

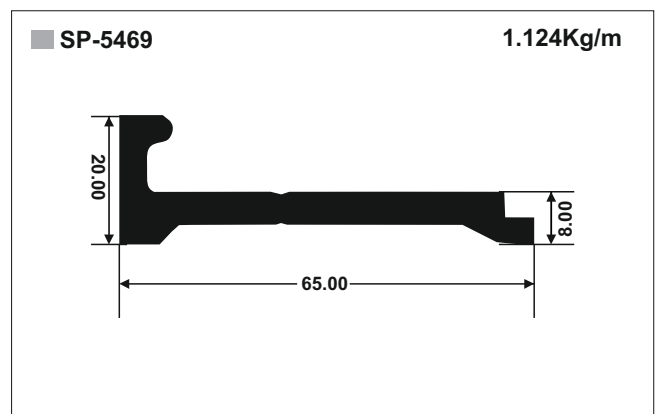
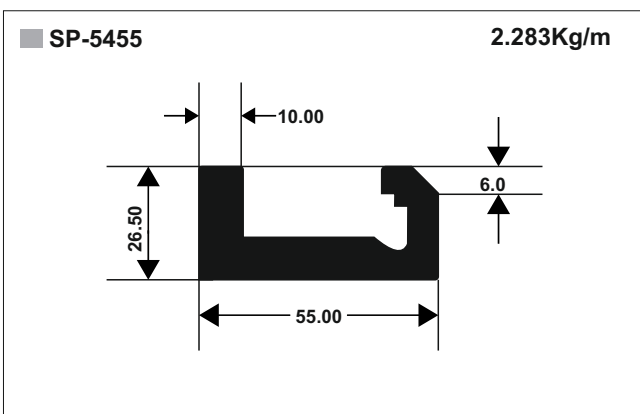
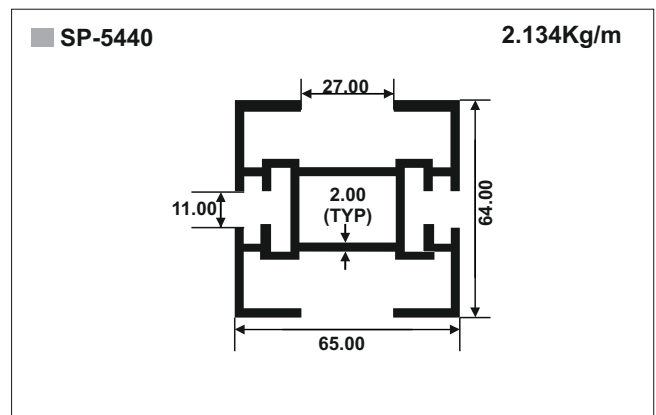
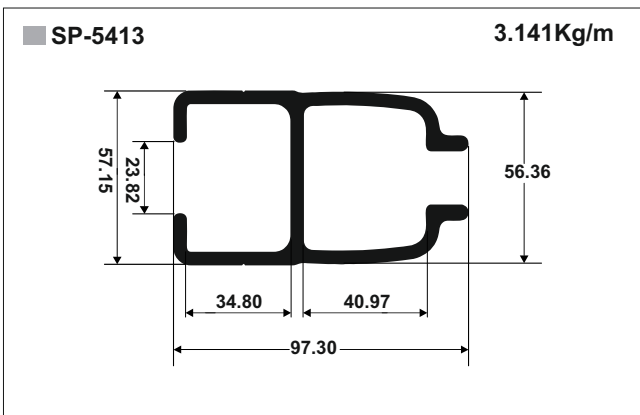
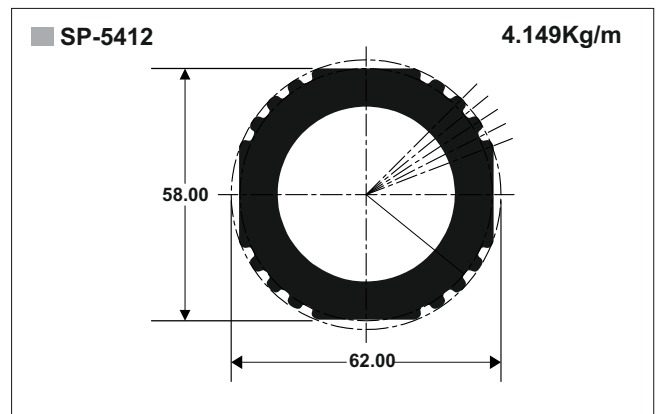
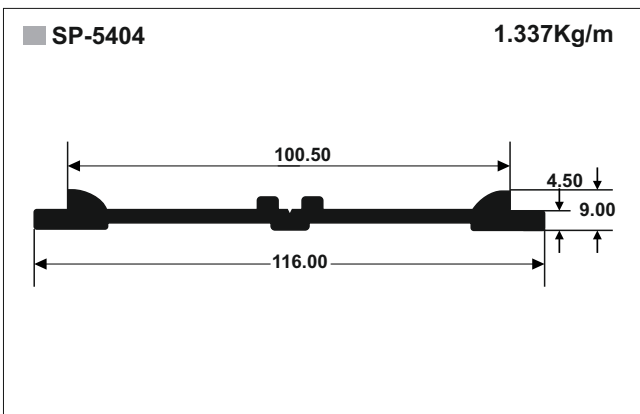
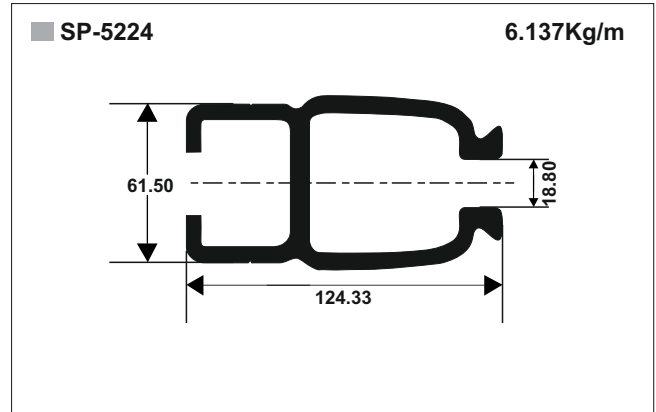
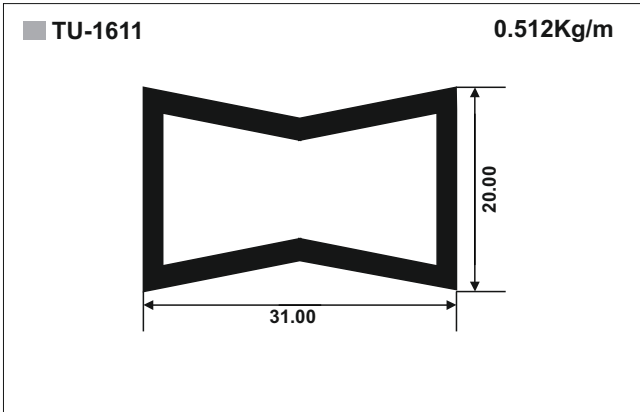



Machine Part

SP-5470

1.199Kg/m

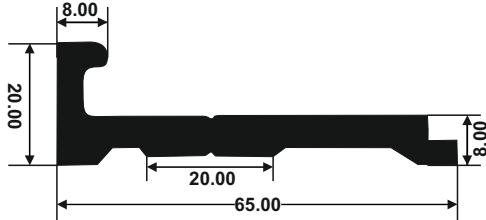

SP-5471

1.372Kg/m



SP-5472

1.479Kg/m

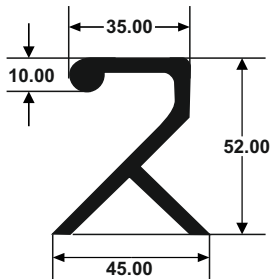

SP-5473

1.050Kg/m

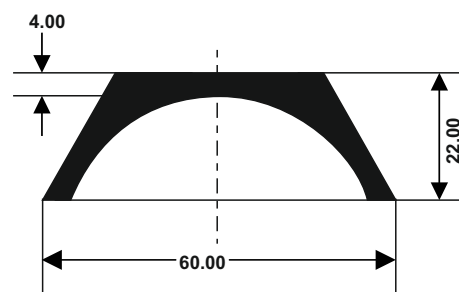

SP-3603

10.867Kg/m

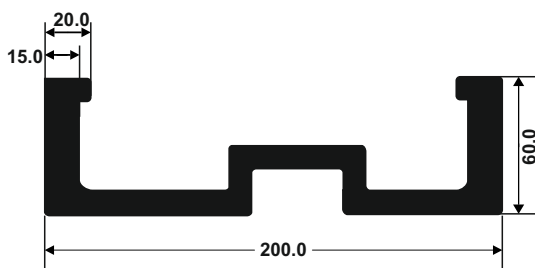

SP-3828

7.310Kg/m

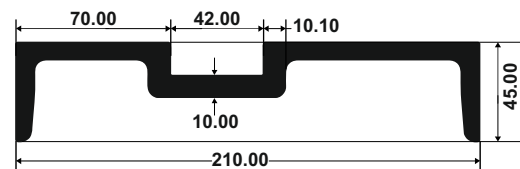

SP-8071

14.440Kg/m

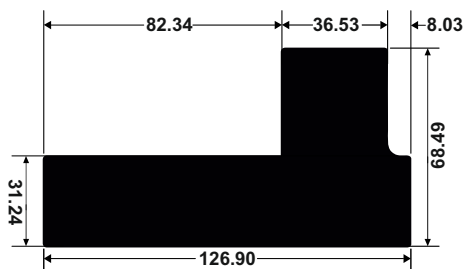

SP-8750

0.885Kg/m

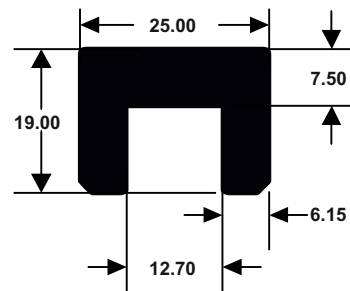



Machine Part

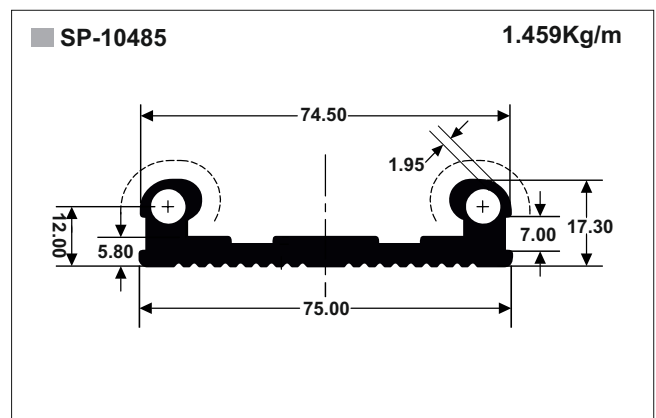
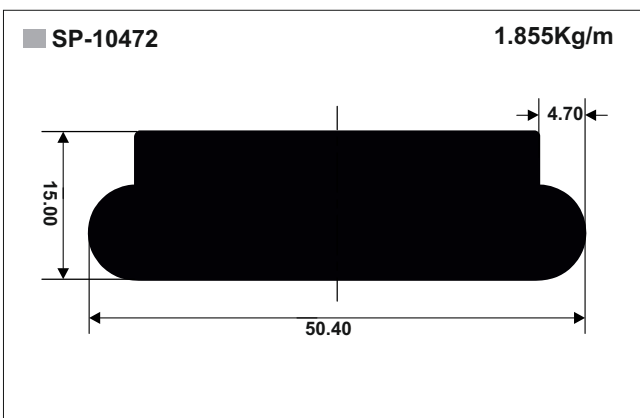
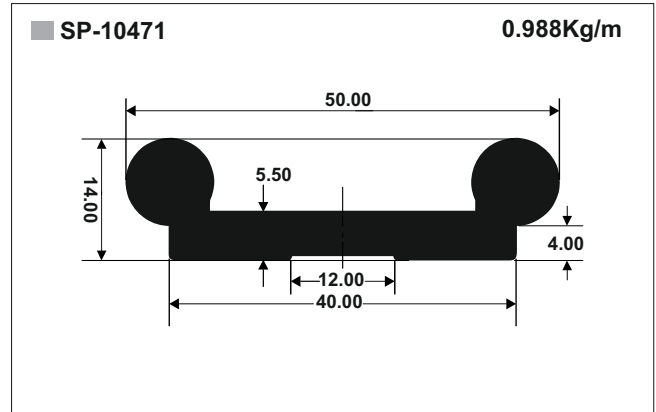
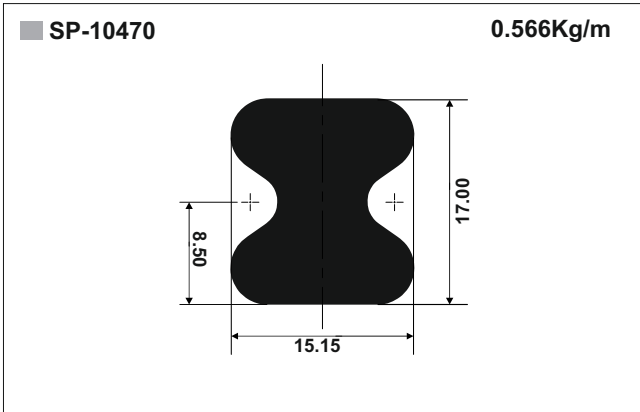

Machine Components

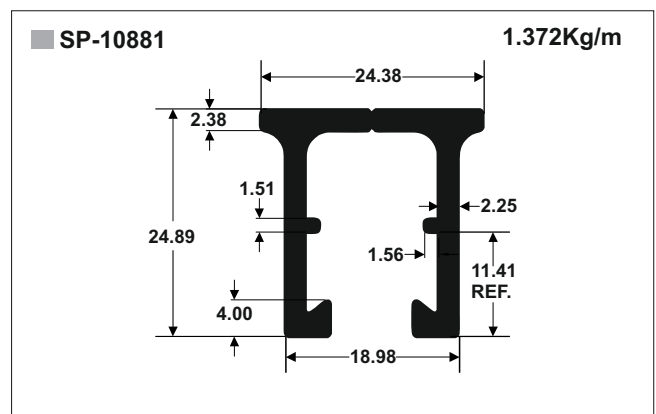
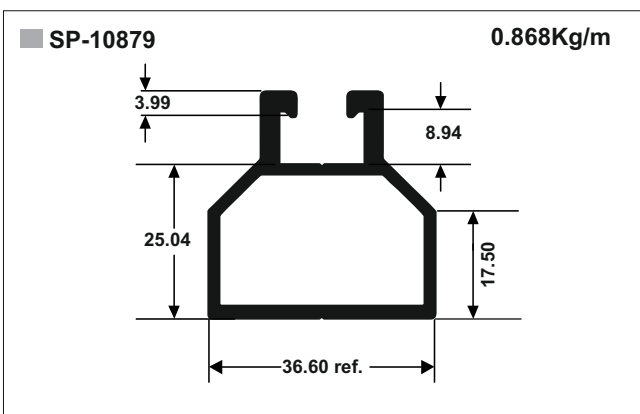
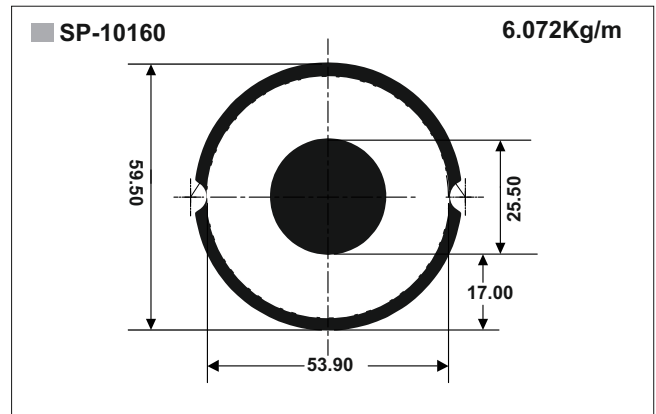
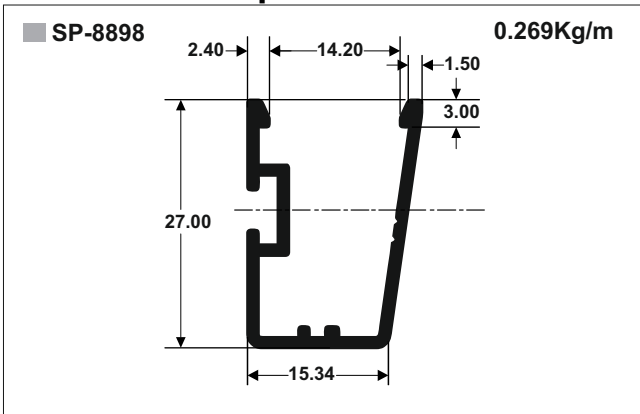



Machine Components

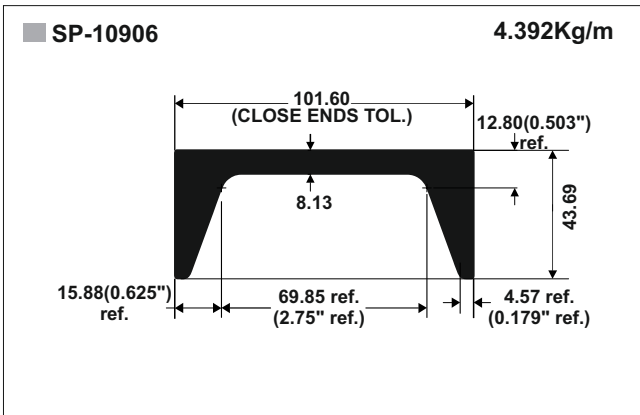

Fishing Tackles

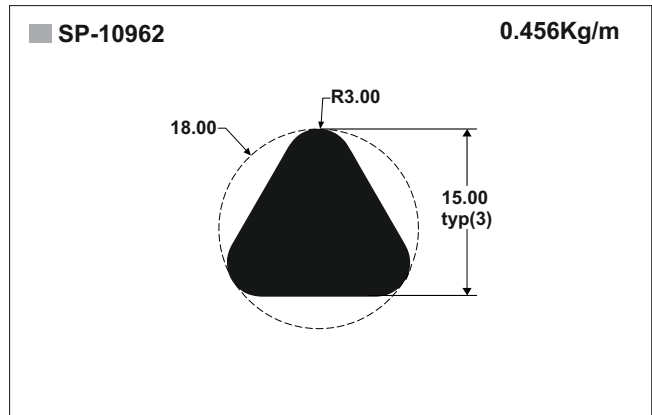

Machine Assembly Component

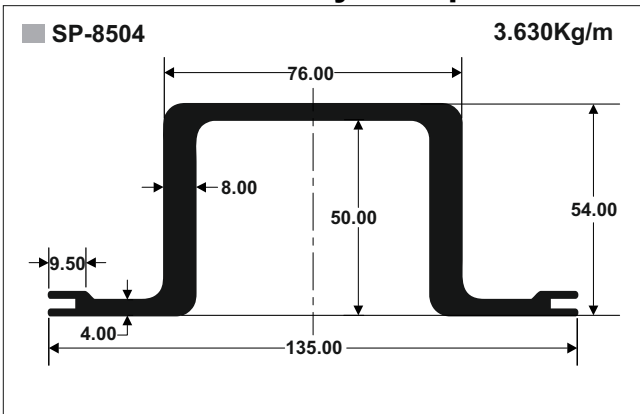

Ferrule

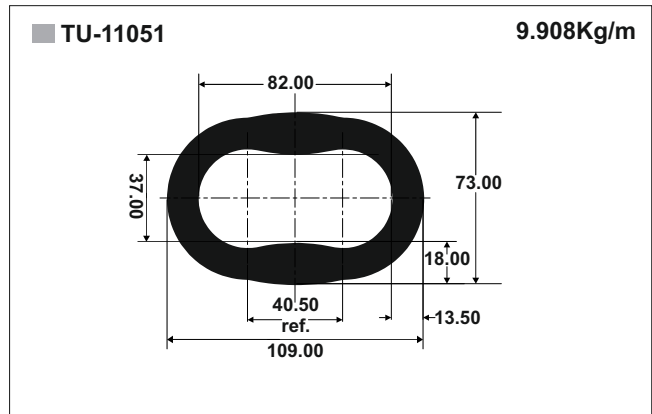

Packing Machine

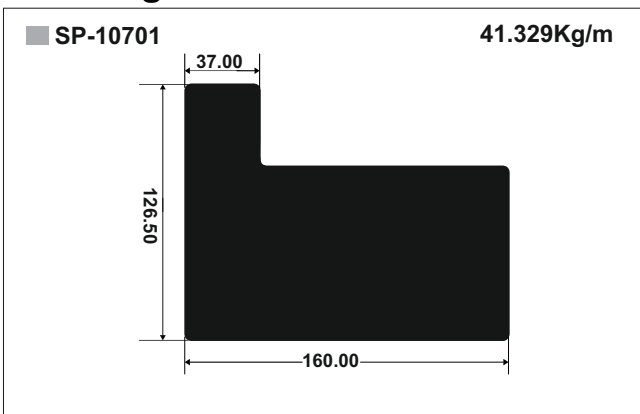

Cover Part

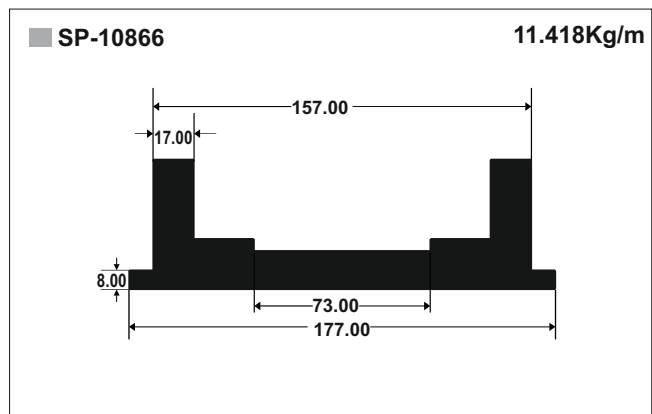



Medical Equipment

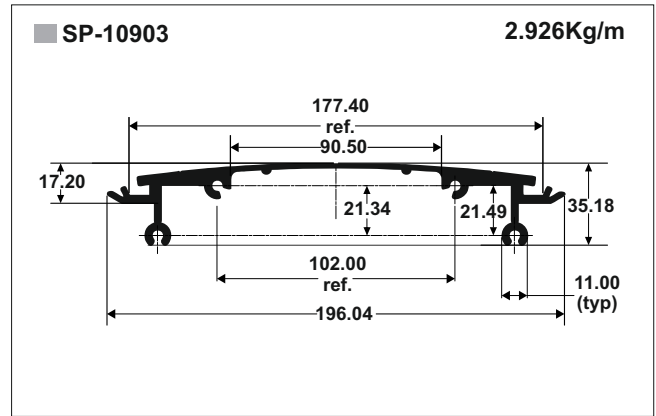
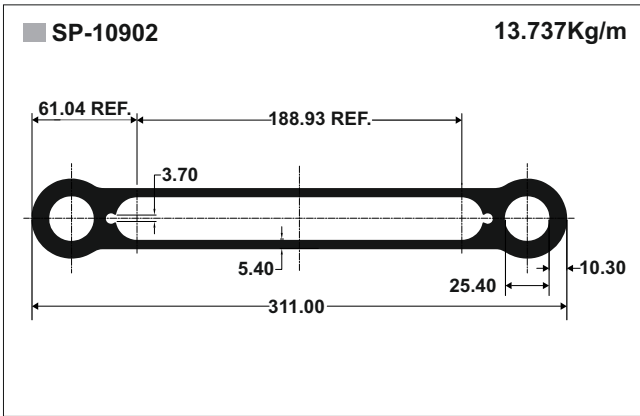
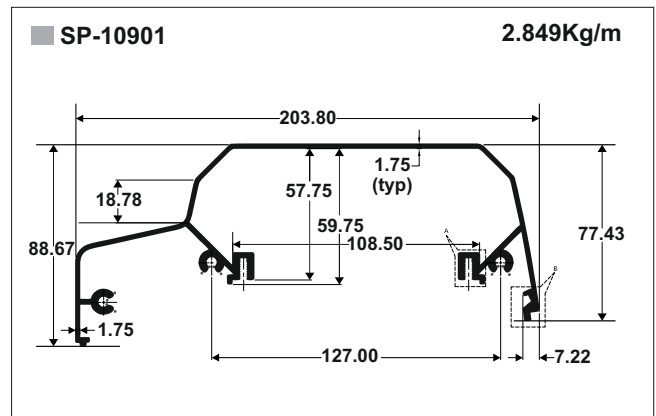
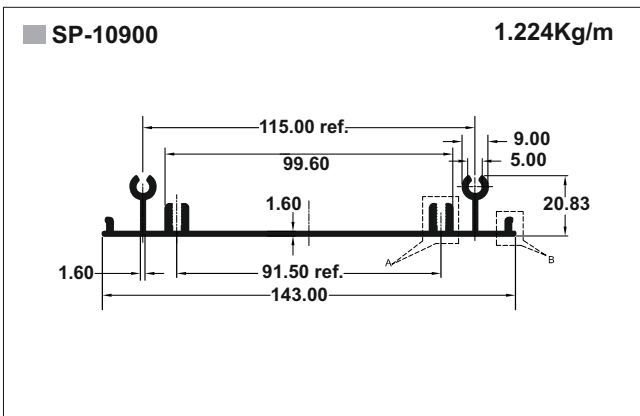
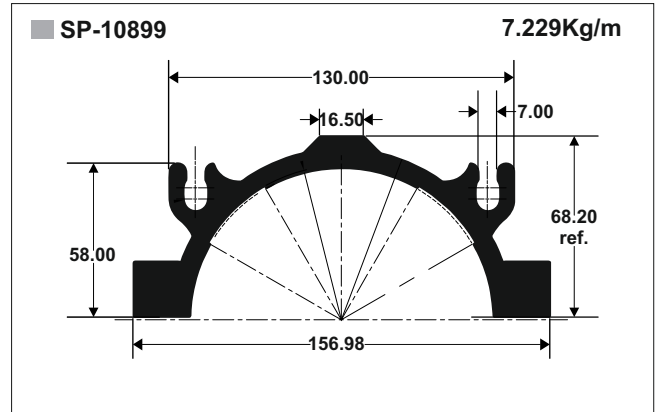
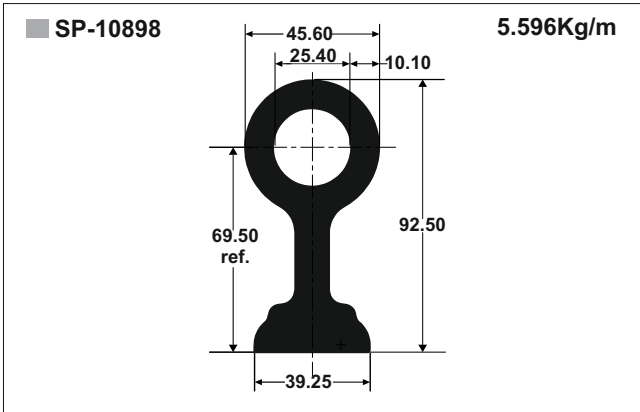

Valcanising Machine

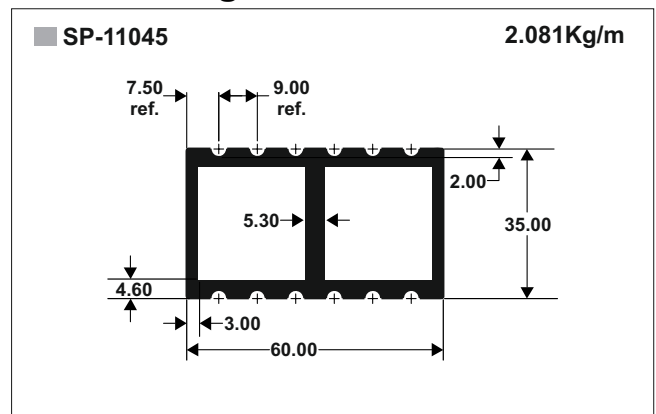
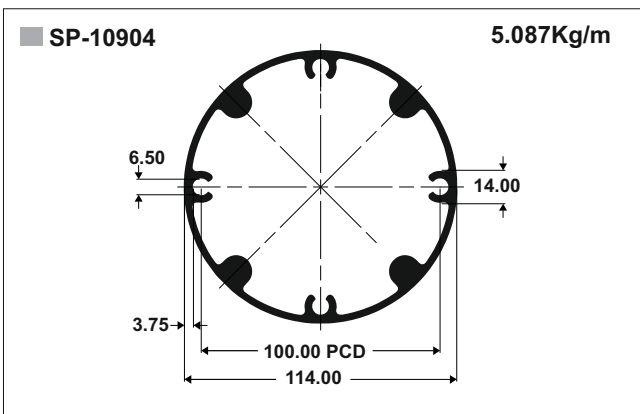



Robot Wheel

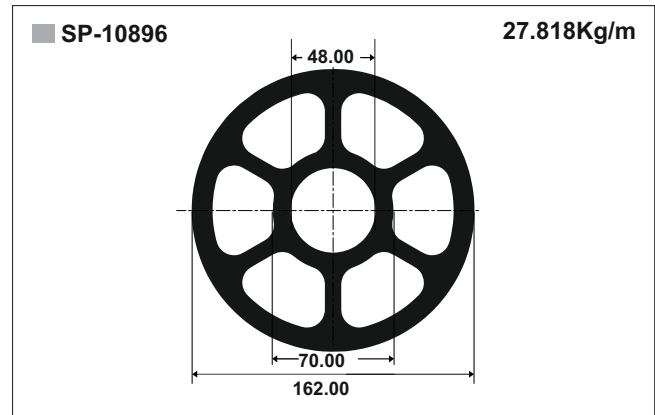
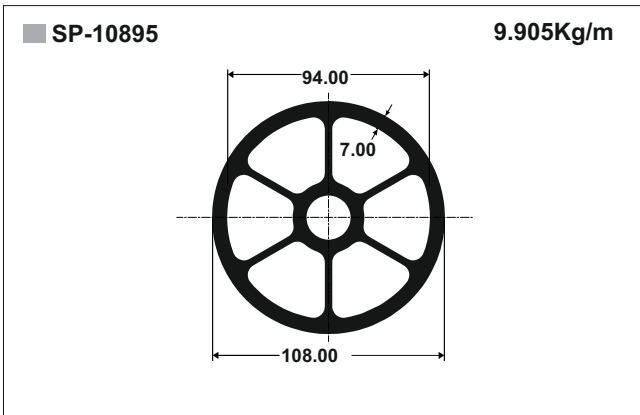

Robot Body

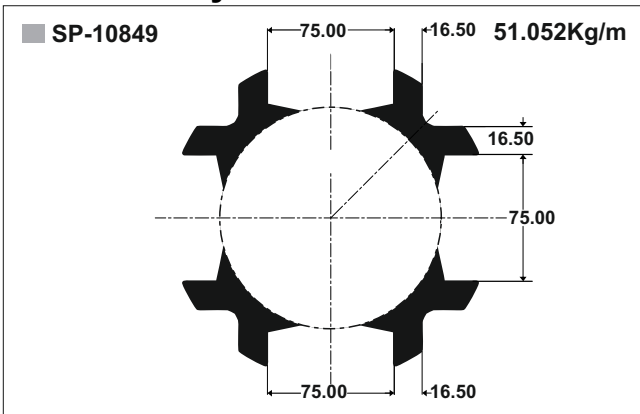



Index

<u>Sec</u>	<u>Page</u>	<u>Sec</u>	<u>Page</u>	<u>Sec</u>	<u>Page</u>				
201	22	4565	12	10145	15				
590	22	4603	26	10146	15				
1145	21	4647	26	10147	15				
1197	25	4653	26	10160	29				
1200	25	4661	26	10206	16				
1385	22	4691	19	10446	23				
1416	22	4694	23	10470	29				
1535	25	4726	14	10471	29				
1579	25	4753	13	10472	29				
1611	27	4778	14	10485	29				
1846	22	4779	14	10529	16				
1936	23	4780	14	10614	23				
2036	23	4798	12	10650	24				
2056	23	4804	18	10701	30				
2302	22	4805	12	10794	24				
2548	21	4912	26	10812	16				
2592	22	5215	12	10849	32				
3103	18	5224	27	10866	30				
3129	21	5296	12	10879	29				
3130	26	5309	14	10881	29				
3154	13	5312	14	10891	16				
3443	12	5318	14	10892	16				
3486	20	5404	27	10893	16				
3487	20	5412	27	10894	16				
3577	19	5413	27	10895	32				
3578	19	5440	27	10896	32				
3603	28	5455	27	10898	31				
3791	21	5462	13	10899	31				
3828	28	5469	27	10900	31				
3872	26	5470	28	10901	31				
3956	20	5471	28	10902	31				
3978	21	5472	28	10903	31				
4228	14	5473	28	10904	31				
4234	18	5645	15	10906	30				
4241	19	5711	15	10911	20				
4242	19	5870	24	10914	16				
4298	18	5980	13	10915	17				
4378	12	6197	15	10916	17				
4383	18	7590	15	10962	30				
4384	18	7965	25	10980	21				
4386	18	7966	25	10987	17				
4413	19	8071	28	10988	17				
4414	19	8235	25	11045	31				
4416	23	8270	13	11051	30				
4437	12	8407	25						
4447	26	8504	30						
4473	23	8750	28						
4482	19	8826	13						
4531	22	8898	29						
4536	21	10143	15						



MARKETING HEAD OFFICE

6th & 7th Floor, Birla Centurion,
Pandurang Budhkar Marg,
Worli, Mumbai 400030
Tel : +91-22-6662 6666 / 6662 6609 / 6643
Fax : +91-22-2422 7586 / 2436 2516
Email : rajendra.pareek@adityabirla.com

EXPORTS OFFICE

7th Floor, Birla Centurion,
Pandurang Budhkar Marg,
Worli, Mumbai 400030
Tel : +91-22-6662 6666 / 6662 6630 / 6646
Fax : +91-22-2422 7586 / 2436 2516
Email : manoj.randive@adityabirla.com

WORKS

P.O. Renukoot, Dist Sonbhadra,
Uttar Pradesh - 231 217, India
Tel. : +91-5446-252 079 / 78
Fax : +91-5446-252 107 / 252 427
Email : sanjeev.singh@adityabirla.com

P.B. No. 21 Alupuram, Kalamassery,
Kerala - 683 104, India
Tel.: +91 - 484 - 293 2446
Fax : +91 - 484 - 254 1887
Email : r.sivaramakrishan@adityabirla.com

REGIONAL OFFICES

North

Mindmill Corporate Tower
24a, Film City
Sec- 16 A,
Noida - 201301.up.
Ph. + 91120 6692100
Fax. 91120 6692105
Email : nutan.singh@adityabirla.com

West

1st floor, Ahura Centre,
82, Mahakali Caves Road, Andheri (East),
Mumbai - 400 093, Maharashtra
Tel.: +91-22-6691 7000 / 7031
Fax : +91-22-6691 7070 / 7050
Email : ashish.nema@adityabirla.com

East

Jeevan Deep Building, 1,
Prafulla Chandra Sen Sarani,
Kolkata - 700 071, West Bengal
Tel.: +91-33-2280 9710, 2288 6135
Fax : +91-33-2288 6139
Email : abhijit.chakraborty@adityabirla.com

South

7th Floor, Industry house,
45 Race Course road,
Bengaluru - 560 001, Karnataka
Tel.: +91-80-4041 6000
Fax : +91-80-4041 6060
Email : ashok.k.kumar@adityabirla.com

AREA OFFICES

Kochi

P.B. No. 21 Alupuram, Kalamassery,
Kerala - 683 104, India
Tel.: +91-484-293 2445
Fax : +91-484-254 1887
Email : vivek.jacob@adityabirla.com

Chennai

Flat 2A, 2nd Floor, Appex Plaza, 3,
Nungambakkam High Road, Chennai - 600 034
Tel.: 91-44-2827 2333 / 2343
Fax : 91-44-2827 4756
Email : s.sugunaraj@adityabirla.com



www.hindalco.com